

ON THE APPLICATION OF OLD BANK MAPPERLEY LIMITED FOR A PREMISES  
LICENCE UNDER LICENSING ACT 2003 FOR THE PREMISES AT 31 PLAINS ROAD  
MAPPERLEY NOTTINGHAM

**LICENSING ACT PANEL**  
**HEARING: THURSDAY 16<sup>TH</sup> December 2021**  
**AT 10.30 AM**

---

**INDEX**

---

No	Description	Date	Page No
1.	<b>PROCEDURE</b>		
1.1	Licensing Panel and Committee Procedure	Undated	1-4
1.2	Matters to be taken into account by the Panel	Undated	5-6
2.	<b>APPLICATION</b>		
2.1	Application for Premises Licence	29 October 2021	7-32
2.2	Plan of Premises	October 21	33

3.	<b>OBJECTIONS-INTERESTED PARTIES</b>			
	3.1	Representation from Gedling Borough Council Environmental Health Officer Terry Buttle	26 November 2021	35-39
	3.2	Representation from Tom Price 17 Bonington Road Mapperley	09 November 2021	40-44
	3.3	Representation from Michael and Rosemary Sanders 60 Steedman Avenue Mapperley	09 November 2021	45-46
	3.4	Representation from Lynda Schippers 13 Bonington Road Mapperley	07 November 2021	47-52
	3.5	Representation from Lawrence McNally 21 Bonington Road Mapperley	06 November 2021	53-58
	3.6	Representation from Kirsty Hingley 8 Bonington Road Mapperley	03 November 2021	59-63
	3.7	Representation from Katy White 1 Bonington Road Mapperley	06 November 2021	64-68
	3.8	Representation from Julie Mathers 18 Bonington Road Mapperley	07 November 2021	69-73
	3.9	Representation from Julie Gamble and Stephen Stapleton 16 Bonington Road Mapperley	08 November 2021	74-78
	3.10	Representation from Harry Lawton 19 Bonington Road Mapperley	09 November 2021	79-83
	3.11	Representation from Mrs P J Mahon 31 Whittingham Road Mapperley	12 November 2021	84-88
	3.12	Representation from Sarah Gregorczyk 34 Bennett Road	12 November 2021	89-93

	3.13	Representation from David Banton 12 Bonington Road Mapperley	12 November 2021	94-98
	3.14	Representation from Alan and Anne Symonds 27 Bonington Road Mapperley	14 November 2021	99-105
	3.15	Representation from Mark Smalley 2 Bonington Road Mapperley	23 November 2021	106-110
	3.16	Representation from Jack Neville 5 Bonington Road Mapperley	23 November 2021	111-115
	3.17	Representation from Stuart Parker 3 Bonington Road Mapperley	26 November 2021	116-120
	3.18	Representation from Nicola Blue 6 Plains Road Mapperley	25 November 2021	121-122
	3.19	Representation from Mr and Mrs Sturtivant 9 Bonington Road Mapperley	25 November 2021	123-127
	3.20	Representation from Carl Jones 6 Bennett Road Mapperley	23 November 2021	128-133
	3.21	Representation from Bruce Roberts 8 Plains Road Mapperley	23 November 2021	134-135
	3.22	Representation from Mark Vasey 1 Gretton Road Mapperley	22 November 2021	136
	3.23	Representation from Linda and George Wildman 10 Bonington Road Mapperley	06 November 2021	137-142
	3.24	Plan showing location of Premise and Objectors in close proximity to 31 Plains Road	Undated	143
4.	<b>OTHER REPRESENTATIONS</b>			
	4.1	Nottinghamshire Police agreed conditions	26 November 2021	145-147

## LICENSING PANEL & COMMITTEE HEARING PROCEDURE

1. Upon notification that a matter is to be put before a Licensing Panel or the Committee, the applicant, interested parties and the responsible authorities shall within the time period provided for in the relevant regulations give notice to the Licensing Office stating
  - i. Whether they intend to be represented at the hearing
  - ii. The names and addresses of any witnesses that they intend to call
  - iii. The time estimate for their presentation/representations to the Committee
  - iv. Whether they consider a hearing to be unnecessary
2. Where a large number of interested parties are involved they will be encouraged to appoint a spokesperson or spokespersons so as to avoid duplication of evidence in so far as is possible.
3. Anyone invited to attend before a Panel or the Committee may bring legal or other professional representatives with them if they so wish. Advocates are, however, reminded that these are civil proceedings and inquisitorial rather than adversarial in nature. Aggressive advocacy is not encouraged and will not be tolerated.
4. Copies of the application and representations made by the parties will have been circulated to members prior to the hearing. However in appropriate cases, where a matter is to proceed to a hearing the applicant will be expected to supply a further 6 copies of the plan accompanying the application for use at the hearing. The hearing will concentrate solely on those areas of the application which are in dispute. The Authority is under an obligation to disregard information which is not relevant to the application, representation, or notice or to the licensing objectives. Advocates are therefore asked to be as succinct as possible and should be aware that the Chair may impose a time limit within which parties are to present their case.
5. Whilst additional material in support of the application, representation or notice may be taken into account by the Authority, such material should be provided and circulated by the producer to all parties concerned (including the Authority) as soon as possible before the hearing. Material produced at the hearing can only be admitted with the consent of all the other parties. The late production of material may lead to a hearing having to be adjourned and is discouraged. Additional material which reveals a new ground of representation or which is not relevant to the application, representation or notice lodged will be disregarded
6. Any party who intends to put additional written material before the Panel or the



Committee should provide 18 copies of that material to the licensing Office if the application is to go to the full Committee and 6 copies if the matter is to go before the Panel. Applicants should note that changes to application plans during the application process should be notified to the licensing Office as soon as possible and are likely to result in a new application having to be submitted. All relevant documentation received by the Authority will be sent to Members of the Panel/Committee and interested parties before the hearing if at all possible. Any failure to adhere to the requirements listed above may result in a case having to be adjourned and therefore delay the decision.

7. Where a party does not attend the hearing and is not represented the Authority may either adjourn the hearing if it is in the public interest to do so, or may continue with the hearing in the party's absence. If the latter option is followed the Committee/Panel will still consider any application, representation, or notice submitted by the absent party in so far as it is relevant.
8. The following procedure will ordinarily be followed at the Panel/Committee hearing:
  - i. The Chair will introduce themselves, other members and relevant officers. The Chair will also ask the applicant, interested parties and the responsible authorities to introduce themselves and any witnesses they wish to call. The Chair will then outline the procedure to be followed by the Panel/Committee and any time limits to be imposed on the presentation of cases.
  - ii. The applicant will be asked to present their case. Where a general presentation is made interested parties and the responsible authorities may ask questions at the end of that presentation. However, where witnesses are called, it is expected that each witness will give their evidence and then be open for questioning once their evidence has finished. The next witness will then give evidence. The order for asking questions will be:
    - Responsible Authorities
    - Interested parties
    - Panel/Committee Members
    - Legal advisor to the Panel/Committee (where appropriate)
  - iii. Responsible authorities, and interested parties will then be given an opportunity to present their representations. Once the representation has been presented and any evidence given, there will be an opportunity for questions to be asked firstly, by the applicant and then by other responsible authorities and interested parties, members and the legal advisor to the Panel/Committee. Where there is more than one body making representations to an application the order for the hearing of representations will normally be the responsible authorities followed by interested parties

- iv. Once all the evidence has been given responsible authorities, and interested parties will be given an opportunity to sum up their representations in the same order as they presented their case. The applicant will then be given an opportunity to sum up their case and have the final word.
  - v. Whilst Hearings will normally be conducted in Public the Panel/Committee does have powers of exclusion (which cover the public, the press, and even applicants, parties and their representatives) in appropriate circumstances. The Panel/Committee will however always discuss and make its decision on the application in private.
  - vi. The decision will normally be announced in public and transmitted in writing in accordance with the relevant rules and guidance. The decision may however be notified where applicable to the parties in writing at a subsequent date following the conclusion of the hearing.
9. If all parties agree and the Authority considers it appropriate, a hearing may be dispensed with. In some circumstances (where representations are not withdrawn), the Panel/Committee may still have to determine the application but will do so having considered the papers previously submitted. In such circumstances the Authority would also consider the terms of any "consent order" drawn up by the parties indicating terms upon which all of the relevant parties would be content that the application be granted.
10. Adjournments
- i. Due to the time constraints upon the Panels/Committee, applications for adjournments will only be granted where absolutely necessary
  - ii. Once a hearing date has been set it is for the parties to ensure that they attend or are represented. Hearings may proceed in the absence of a party and in such circumstances the party's original representations will be taken into account together with any further material in support of that representation which has been served on all parties before the day of the hearing.
  - iii. If it is not possible for a party or their witness to attend a hearing the Authority's preference would be for their representation to proceed by way of written evidence
  - iv. If it is necessary to make an application for an adjournment the party seeking the adjournment should seek the consent of all other parties to the application and notify the Licensing Office as soon as possible that an adjournment may be sought. If all parties agree the matter may be adjourned administratively.
  - v. If not agreed administratively the matter will remain listed before the Panel/ Committee to hear the application and determine whether to agree the adjournment or proceed.
  - vi. The Authority may adjourn proceedings of its own motion where it considers it necessary for its consideration of any application, representations or notice made or where it considers it to be in the interests of natural justice.
  - vii. Where an adjournment is granted all parties will be given notice of the adjournment and the new hearing date.

## 11. Applications to Extend Time Limits

- i. These may be dealt with administratively but will only be granted where it is necessary in the public interest.
- ii. Applications should be made to the Licensing Officer identifying:-
  - i. the licensing application and premises concerned,
  - ii. the person making the application for the time limit to be extended
  - iii. the time limit concerned,
  - iv. the reasons why that time limit cannot be complied with,
  - v. the extension sought,
  - vi. why it is believed that it would be in the interests of justice to grant the application, and
  - vii. whether all other parties have agreed to an extension of time.
- iii. Where an extension is granted all parties will be given notice of the extension.

## THE PANEL'S CONSIDERATIONS

The Panel will disregard any information given or evidence produced, which is not relevant to the application or the promotion of the licensing objectives.

**The Objectives are: -**

- **The prevention of crime and disorder;**
- **Public safety;**
- **The prevention of public nuisance, and**
- **The protection of children from harm.**

Each objective is of equal importance.

The Panel will have regard to the national Guidance issued under Section 182 of the Licensing Act 2003 and the Borough Council's own Statement of Licensing Policy.

The Panel has a duty to act in a manner which is compatible with the Human Rights Act 1998.

A Licence is regarded as property for the purposes of the Human Rights Act 1998. Article 1 of the First Protocol states that:

"Every natural or legal person is entitled to the peaceful enjoyment of his possessions. No one shall be deprived of his possessions except in the public interest and subject to the conditions provided for by law and by the general principles of international law.

The preceding provisions shall not, however, in any way impair the right of a State to enforce such laws as it deems necessary to control the use of property in accordance with the general interest or to secure the payment of taxes or other contributions or penalties."

The Panel must also take into account the effect on local residents. Article 8 states:

"1. Everyone has the right to respect for his private and family life, his home and his correspondence.

2. There shall be no interference by a public authority with the exercise of this right except such as is in accordance with the law and is necessary in a democratic society in the interests of national security, public safety or the economic well-being of the country, for the prevention of disorder or crime, for the protection of health or morals, or for the protection of the rights and freedoms of others."

Three stage test to be applied: -

1. Is the interference in accordance with the law?
2. Is the interference necessary in a democratic society in pursuit of one of the legitimate aims set out above?
3. Is the decision proportionate i.e. striking a fair balance between the demands of the general interests of the community and the requirement to protect the individual's fundamental rights?

2

# APPLICATION

**Application for a premises licence to be granted under the Licensing Act 2003**

**PLEASE READ THE FOLLOWING INSTRUCTIONS FIRST**

Before completing this form please read the guidance notes at the end of the form. If you are completing this form by hand please write legibly in block capitals. In all cases ensure that your answers are inside the boxes and written in black ink. Use additional sheets if necessary.

You may wish to keep a copy of the completed form for your records.

**I/We** Old Bank Mapperley Limited

*(Insert name(s) of applicant)*

**apply for a premises licence under section 17 of the Licensing Act 2003 for the premises described in Part 1 below (the premises) and I/we are making this application to you as the relevant licensing authority in accordance with section 12 of the Licensing Act 2003**

**Part 1 – Premises details**

Postal address of premises or, if none, ordnance survey map reference or description			
31 Plains Road Mapperley Nottingham			
<b>Post town</b>		<b>Postcode</b>	NG3 5JU

Telephone number at premises (if any)	
Non-domestic rateable value of premises	<b>£24,500</b>

**Part 2 - Applicant details**

Please state whether you are applying for a premises licence as      **Please tick as appropriate**

- |     |  |                                     |                             |
|-----|--|-------------------------------------|-----------------------------|
| a)  | an individual or individuals *                     | <input type="checkbox"/>            | please complete section (A) |
| b)  | a person other than an individual *                |                                     |                             |
| i   | as a limited company/limited liability partnership | <input checked="" type="checkbox"/> | please complete section (B) |
| ii  | as a partnership (other than limited liability)    | <input type="checkbox"/>            | please complete section (B) |
| iii | as an unincorporated association or                | <input type="checkbox"/>            | please complete section (B) |
| iv  | other (for example a statutory corporation)        | <input type="checkbox"/>            | please complete section (B) |
| c)  | a recognised club                                  | <input type="checkbox"/>            | please complete section (B) |
| d)  | a charity  | <input type="checkbox"/>            | please complete section (B) |

- e) the proprietor of an educational establishment ☐ please complete section (B)
- f) a health service body ☐ please complete section (B)
- g) a person who is registered under Part 2 of the Care Standards Act 2000 (c14) in respect of an independent hospital in Wales ☐ please complete section (B)
- ga) a person who is registered under Chapter 2 of Part 1 of the Health and Social Care Act 2008 (within the meaning of that Part) in an independent hospital in England ☐ please complete section (B)
- h) the chief officer of police of a police force in England and Wales ☐ please complete section (B)

\* If you are applying as a person described in (a) or (b) please confirm (by ticking yes to one box below):

I am carrying on or proposing to carry on a business which involves the use of the premises for licensable activities; or ☒

I am making the application pursuant to a

statutory function or ☐

a function discharged by virtue of Her Majesty's prerogative ☐

**(A) INDIVIDUAL APPLICANTS** (fill in as applicable)

Mr <input type="checkbox"/>	Mrs <input type="checkbox"/>	Miss <input type="checkbox"/>	Ms <input type="checkbox"/>	Other Title (for example, Rev)	
<b>Surname</b>			<b>First names</b>		
<b>Date of birth</b>			I am 18 years old or over <input type="checkbox"/> Please tick yes		
<b>Nationality</b>					
Current residential address if different from premises address					
Post town				Postcode	
<b>Daytime contact telephone number</b>					
<b>E-mail address (optional)</b>					
Where applicable (if demonstrating a right to work via the Home Office online right to work checking service), the 9-digit 'share code' provided to the applicant by that service (please see note 15 for information)					



**SECOND INDIVIDUAL APPLICANT** (if applicable)

Mr <input type="checkbox"/>	Mrs <input type="checkbox"/>	Miss <input type="checkbox"/>	Ms <input type="checkbox"/>	Other Title (for example, Rev)	
<b>Surname</b>			<b>First names</b>		
<b>Date of birth</b>		I am 18 years old or over		<input type="checkbox"/>	Please tick yes
<b>Nationality</b>					
Where applicable (if demonstrating a right to work via the Home Office online right to work checking service), the 9-digit 'share code' provided to the applicant by that service: (please see note 15 for information)					
Current residential address if different from premises address					
Post town				Postcode	
<b>Daytime contact telephone number</b>					
<b>E-mail address (optional)</b>					

**(B) OTHER APPLICANTS**

**Please provide name and registered address of applicant in full. Where appropriate please give any registered number. In the case of a partnership or other joint venture (other than a body corporate), please give the name and address of each party concerned.**

<b>Name</b>
Old Bank Mapperley Limited
<b>Address</b>
326 - 330 Hucknall Road Sherwood Nottingham NG5 1FS
<b>Registered number (where applicable)</b>
13581932

Description of applicant (for example, partnership, company, unincorporated association etc.) Limited Company
Telephone number (if any)
E-mail address (optional)

### Part 3 Operating Schedule

When do you want the premises licence to start?

DD	MM	YYYY
A	S	A P

If you wish the licence to be valid only for a limited period, when do you want it to end?

DD	MM	YYYY

Please give a general description of the premises (please read guidance note 1)

Bar/Restaurant

If 5,000 or more people are expected to attend the premises at any one time, please state the number expected to attend.

What licensable activities do you intend to carry on from the premises?

(please see sections 1 and 14 and Schedules 1 and 2 to the Licensing Act 2003)

Provision of regulated entertainment (please read guidance note 2)

Please tick all that apply

- |  |                                     |
|--|-------------------------------------|
| a) plays (if ticking yes, fill in box A)                             | <input checked="" type="checkbox"/> |
| b) films (if ticking yes, fill in box B)                             | <input checked="" type="checkbox"/> |
| c) indoor sporting events (if ticking yes, fill in box C)            | <input checked="" type="checkbox"/> |
| d) boxing or wrestling entertainment (if ticking yes, fill in box D) | <input type="checkbox"/>            |
| e) live music (if ticking yes, fill in box E)                        | <input checked="" type="checkbox"/> |

- f) recorded music (if ticking yes, fill in box F) ☒
- g) performances of dance (if ticking yes, fill in box G) ☒
- h) anything of a similar description to that falling within (e), (f) or (g)  
(if ticking yes, fill in box H) ☒

**Provision of late night refreshment** (if ticking yes, fill in box I) ☒

**Supply of alcohol** (if ticking yes, fill in box J) ☒

**In all cases complete boxes K, L and M**

# A

<b>Plays</b> Standard days and timings (please read guidance note 7)			<b><u>Will the performance of a play take place indoors or outdoors or both – please tick</u></b> (please read guidance note 3)	Indoors	<input checked="" type="checkbox"/>
				Outdoors	<input type="checkbox"/>
				Both	<input type="checkbox"/>
Day	Start	Finish			
Mon	08:00	02:00	<b><u>Please give further details here</u></b> (please read guidance note 4)		
Tue	08:00	02:00			
Wed	08:00	02:00	<b><u>State any seasonal variations for performing plays</u></b> (please read guidance note 5)		
Thur	08:00	02:00			
Fri	08:00	02:00	<b><u>Non standard timings. Where you intend to use the premises for the performance of plays at different times to those listed in the column on the left, please list</u></b> (please read guidance note 6)  If applicable, an additional hour to the standard and non-standard times on the day when British summertime comences.  From the standard start timing on 31 <sup>st</sup> December to the standard start time on the 1 <sup>st</sup> January.		
Sat	08:00	02:00			
Sun	08:00	02:00			

## B

<b>Films</b> Standard days and timings (please read guidance note 7)			<b><u>Will the exhibition of films take place indoors or outdoors or both – please tick</u></b> (please read guidance note 3)	Indoors	<input checked="" type="checkbox"/>
				Outdoors	<input type="checkbox"/>
				Both	<input type="checkbox"/>
Day	Start	Finish	<b><u>Please give further details here</u></b> (please read guidance note 4)  Occasional exhibition of films.		
Mon	08:00	02:00			
Tue	08:00	02:00	<b><u>State any seasonal variations for the exhibition of films</u></b> (please read guidance note 5)		
Wed	08:00	02:00			
Thur	08:00	02:00	<b><u>Non standard timings. Where you intend to use the premises for the exhibition of films at different times to those listed in the column on the left, please list</u></b> (please read guidance note 6)  If applicable, an additional hour to the standard and non-standard times on the day when British summertime comences.		
Fri	08:00	02:00			
Sat	08:00	02:00	From the standard start timing on 31 <sup>st</sup> December to the standard start time on the 1 <sup>st</sup> January.		
Sun	08:00	02:00			

# C

<b>Indoor sporting events</b> Standard days and timings (please read guidance note 7)			<b><u>Please give further details</u></b> (please read guidance note 4)  Occasional games usually played on licensed premises.
Day	Start	Finish	
Mon	08:00	02:00	
Tue	08:00	02:00	<b><u>State any seasonal variations for indoor sporting events</u></b> (please read guidance note 5)
Wed	08:00	02:00	
			<b><u>Non standard timings. Where you intend to use the premises for indoor sporting events at different times to those listed in the column on the left, please list</u></b> (please read guidance note 6)  If applicable, an additional hour to the standard and non-standard times on the day when British summertime commences.  From the standard start timing on 31 <sup>st</sup> December to the standard start time on the 1 <sup>st</sup> January.
Thur	08:00	02:00	
Fri	08:00	02:00	
Sat	08:00	02:00	
Sun	08:00	02:00	

## D

<b>Boxing or wrestling entertainments</b> Standard days and timings (please read guidance note 7)			<b><u>Will the boxing or wrestling entertainment take place indoors or outdoors or both – please tick</u></b> (please read guidance note 3)	Indoors	<input type="checkbox"/>
				Outdoors	<input type="checkbox"/>
				Both	<input type="checkbox"/>
Day	Start	Finish	<b><u>Please give further details here</u></b> (please read guidance note 4)		
Mon					
Tue			<b><u>State any seasonal variations for boxing or wrestling entertainment</u></b> (please read guidance note 5)		
Wed					
Thur			<b><u>Non standard timings. Where you intend to use the premises for boxing or wrestling entertainment at different times to those listed in the column on the left, please list</u></b> (please read guidance note 6)		
Fri					
Sat					
Sun					

## E

<b>Live music</b> Standard days and timings (please read guidance note 7)			<b><u>Will the performance of live music take place indoors or outdoors or both – please tick</u></b> (please read guidance note 3)	Indoors	<input checked="" type="checkbox"/>
				Outdoors	<input type="checkbox"/>
				Both	<input type="checkbox"/>
Day	Start	Finish	<b><u>Please give further details here</u></b> (please read guidance note 4)  Occasional unamplified and amplified music by various artists/groups.		
Mon	08:00	02:00			
Tue	08:00	02:00			
Wed	08:00	02:00	<b><u>State any seasonal variations for the performance of live music</u></b> (please read guidance note 5)		
Thur	08:00	02:00			
Fri	08:00	02:00			
Sat	08:00	02:00	<b><u>Non standard timings. Where you intend to use the premises for the performance of live music at different times to those listed in the column on the left, please list</u></b> (please read guidance note 6)  If applicable, an additional hour to the standard and non-standard times on the day when British summertime comences.		
Sun	08:00	02:00			
			From the standard start timing on 31 <sup>st</sup> December to the standard start time on the 1 <sup>st</sup> January.		



## F

<b>Recorded music</b> Standard days and timings (please read guidance note 7)			<b><u>Will the playing of recorded music take place indoors or outdoors or both – please tick</u></b> (please read guidance note 3)	Indoors	<input checked="" type="checkbox"/>
				Outdoors	<input type="checkbox"/>
				Both	<input type="checkbox"/>
Day	Start	Finish	<b><u>Please give further details here</u></b> (please read guidance note 4)		
Mon	08:00	02:00			
Tue	08:00	02:00			
Wed	08:00	02:00	<b><u>State any seasonal variations for the playing of recorded music</u></b> (please read guidance note 5)		
Thur	08:00	02:00			
Fri	08:00	02:00			
Sat	08:00	02:00	<b><u>Non standard timings. Where you intend to use the premises for the playing of recorded music at different times to those listed in the column on the left, please list</u></b> (please read guidance note 6)  If applicable, an additional hour to the standard and non-standard times on the day when British summertime comences.		
Sun	08:00	02:00			
			From the standard start timing on 31 <sup>st</sup> December to the standard start time on the 1 <sup>st</sup> January.		

# G

<b>Performances of dance</b> Standard days and timings (please read guidance note 7)			<b><u>Will the performance of dance take place indoors or outdoors or both – please tick</u></b> (please read guidance note 3)	Indoors	<input checked="" type="checkbox"/>
				Outdoors	<input type="checkbox"/>
				Both	<input type="checkbox"/>
Day	Start	Finish	<b><u>Please give further details here</u></b> (please read guidance note 4)  Occasional performance of dance by various artists/groups.		
Mon	08:00	02:00			
Tue	08:00	02:00			
Wed	08:00	02:00	<b><u>State any seasonal variations for the performance of dance</u></b> (please read guidance note 5)		
Thur	08:00	02:00			
Fri	08:00	02:00			
Sat	08:00	02:00	<b><u>Non standard timings. Where you intend to use the premises for the performance of dance at different times to those listed in the column on the left, please list</u></b> (please read guidance note 6)  If applicable, an additional hour to the standard and non-standard times on the day when British summertime comences.		
Sun	08:00	02:00			
			From the standard start timing on 31 <sup>st</sup> December to the standard start time on the 1 <sup>st</sup> January.		

## H

<b>Anything of a similar description to that falling within (e), (f) or (g)</b> Standard days and timings (please read guidance note 7)			Please give a description of the type of entertainment you will be providing		
Day	Start	Finish	<b><u>Will this entertainment take place indoors or outdoors or both – please tick</u></b> (please read guidance note 3)	Indoors	<input checked="" type="checkbox"/>
Mon	08:00	02:00		Outdoors	<input type="checkbox"/>
				Both	<input type="checkbox"/>
Tue	08:00	02:00	<b><u>Please give further details here</u></b> (please read guidance note 4)		
Wed	08:00	02:00			
Thur	08:00	02:00	<b><u>State any seasonal variations for entertainment of a similar description to that falling within (e), (f) or (g)</u></b> (please read guidance note 5)		
Fri	08:00	02:00			
Sat	08:00	02:00	<b><u>Non standard timings. Where you intend to use the premises for the entertainment of a similar description to that falling within (e), (f) or (g) at different times to those listed in the column on the left, please list</u></b> (please read guidance note 6)		
Sun	08:00	02:00			
			If applicable, an additional hour to the standard and non-standard times on the day when British summertime comences.  From the standard start timing on 31 <sup>st</sup> December to the standard start time on the 1 <sup>st</sup> January.		

# I

<b>Late night refreshment</b> Standard days and timings (please read guidance note 7)			<b>Will the provision of late night refreshment take place indoors or outdoors or both – please tick</b> (please read guidance note 3)	Indoors	<input type="checkbox"/>
				Outdoors	<input type="checkbox"/>
				Both	<input checked="" type="checkbox"/>
Day	Start	Finish	<b><u>Please give further details here</u></b> (please read guidance note 4)		
Mon	23:00	02:00			
Tue	23:00	02:00			
Wed	23:00	02:00	<b><u>State any seasonal variations for the provision of late night refreshment</u></b> (please read guidance note 5)		
Thur	23:00	02:00			
Fri	23:00	02:00			
Sat	23:00	02:00	<b><u>Non standard timings. Where you intend to use the premises for the provision of late night refreshment at different times, to those listed in the column on the left, please list</u></b> (please read guidance note 6)  If applicable, an additional hour to the standard and non-standard times on the day when British summertime commences.  From the standard start timing on 31 <sup>st</sup> December to the standard start time on the 1 <sup>st</sup> January.		
Sun	23:00	02:00			

# J

<b>Supply of alcohol</b> Standard days and timings (please read guidance note 7)			<b><u>Will the supply of alcohol be for consumption – please tick</u></b> (please read guidance note 8)	On the premises	<input type="checkbox"/>
				Off the premises	<input type="checkbox"/>
				Both	<input checked="" type="checkbox"/>
Day	Start	Finish	<b><u>State any seasonal variations for the supply of alcohol</u></b> (please read guidance note 5)		
Mon	08:00	02:00			
Tue	08:00	02:00			
Wed	08:00	02:00			
Thur	08:00	02:00			
Fri	08:00	02:00			
Sat	08:00	02:00			
Sun	08:00	02:00	<b><u>Non standard timings. Where you intend to use the premises for the supply of alcohol at different times to those listed in the column on the left, please list</u></b> (please read guidance note 6)  If applicable, an additional hour to the standard and non-standard times on the day when British summertime commences.  From the standard start timing on 31 <sup>st</sup> December to the standard start time on the 1 <sup>st</sup> January.		

**State the name and details of the individual whom you wish to specify on the licence as designated premises supervisor (Please see declaration about the entitlement to work in the checklist at the end of the form):**

<b>Name</b> To be appointed in due course.	
<b>Date of birth</b>	
<b>Address</b>	
<b>Postcode</b>	
<b>Personal licence number (if known)</b>	
<b>Issuing licensing authority (if known)</b>	

## K

**Please highlight any adult entertainment or services, activities, other entertainment or matters ancillary to the use of the premises that may give rise to concern in respect of children** (please read guidance note 9).

As far as the applicant is aware none of the proposed activities should give rise to concern in respect of children.

## L

<b>Hours premises are open to the public</b> Standard days and timings (please read guidance note 7)			<b><u>State any seasonal variations</u></b> (please read guidance note 5)
Day	Start	Finish	
Mon	06:00	02:30	
Tue	06:00	02:30	
Wed	06:00	02:30	
Thur	06:00	02:30	
Fri	06:00	02:30	
Sat	06:00	02:30	
Sun	06:00	02:30	<b><u>Non standard timings. Where you intend the premises to be open to the public at different times from those listed in the column on the left, please list</u></b> (please read guidance note 6)  If applicable, an additional hour to the standard and non-standard times on the day when British summertime commences.  From the standard start timing on 31 <sup>st</sup> December to the standard start time on the 1 <sup>st</sup> January.

## M

Describe the steps you intend to take to promote the four licensing objectives:

### **a) General – all four licensing objectives (b, c, d and e) (please read guidance note 10)**

The licensing objectives have been considered taking into account the nature of the premises and the proposed style of operation.

The premises will operate in accordance with all relevant legislation.

The premises will liaise and co-cooperate with the Responsible Authorities.

### **b) The prevention of crime and disorder**

- 1 A CCTV system with recording equipment shall be installed prior to the premises carrying out licensable activities and maintained in accordance with the system. It shall be recording at all times the premises is open to the public.

All recordings used in conjunction with CCTV shall:

1. be of evidential quality
  2. cover the point of sale, outside area and entrance and exit
  3. indicate the time and date
  4. be retained for a period of 31 days
  5. sufficient staff will be trained to use the system
  6. the original images will be made available for inspection immediately upon the request of Police officers, or other authorised officers.
  7. copies of recordings shall be provided in a format which can be viewed on readily available equipment without the need for specialist software.
- 2 All members of staff engaged in the sale of alcohol, except personal licence holders, shall be trained in the retail sale of alcohol. The training shall be ongoing and each relevant member of staff shall be reviewed every six months. All details of the level of training shall be recorded in a bound and sequentially paginated book or electronic record. This information shall be made available for inspection and copying by the Police or any other authorised person on request and all such books shall be retained at the premises for at least 12 months.
- 3 A bound and sequentially paginated incident book or electronic record shall be kept to record all instances of disorder, damage to property and personal injury at the premises. This book shall be made available for inspection and copying by the Police or any other authorised person upon request and all such books shall be retained at the premises for at least 12 months.

**c) Public safety**

The premises will operate in accordance with all relevant legislation which promotes the prevention of public safety objective. For example, the Health & Safety and Food Safety legislation

The premises will liaise and co-operate with the Responsible Authorities.

**d) The prevention of public nuisance**

The premises will operate in accordance with all relevant legislation which promotes the prevention of public nuisance objective. For example, Environmental Protection Act 1990.

Arrangements for the storage and disposal of refuse will not cause a nuisance.

The premises will liaise and co-operate with the Responsible Authorities.

**e) The protection of children from harm**

A Challenge 21 scheme must operate at the premises. Any person who appears to be under 21 years of age must not be served alcohol unless they produce an acceptable form of identification (passport, photo driving licence, Military Identity card or PASS accredited card).

**Checklist:**

**Please tick to indicate agreement**

- I have made or enclosed payment of the fee. ☒
- I have enclosed the plan of the premises. ☒
- I have sent copies of this application and the plan to responsible authorities and others where applicable. ☐
- I have enclosed the consent form completed by the individual I wish to be designated premises supervisor, if applicable. ☐
- I understand that I must now advertise my application. ☒
- I understand that if I do not comply with the above requirements my application will be rejected. ☒
- [Applicable to all individual applicants, including those in a partnership which is not a limited liability partnership, but not companies or limited liability partnerships] I have included documents demonstrating my entitlement to work in the United Kingdom or my share code issued by the Home Office online right to work checking service (please read note 15). ☐

**IT IS AN OFFENCE, UNDER SECTION 158 OF THE LICENSING ACT 2003, TO MAKE A FALSE STATEMENT IN OR IN CONNECTION WITH THIS APPLICATION. THOSE WHO MAKE A FALSE STATEMENT MAY BE LIABLE ON SUMMARY CONVICTION TO A FINE OF ANY AMOUNT.**



**IT IS AN OFFENCE UNDER SECTION 24B OF THE IMMIGRATION ACT 1971 FOR A PERSON TO WORK WHEN THEY KNOW, OR HAVE REASONABLE CAUSE TO BELIEVE, THAT THEY ARE DISQUALIFIED FROM DOING SO BY REASON OF THEIR IMMIGRATION STATUS. THOSE WHO EMPLOY AN ADULT WITHOUT LEAVE OR WHO IS SUBJECT TO CONDITIONS AS TO EMPLOYMENT WILL BE LIABLE TO A CIVIL PENALTY UNDER SECTION 15 OF THE IMMIGRATION, ASYLUM AND NATIONALITY ACT 2006 AND PURSUANT TO SECTION 21 OF THE SAME ACT, WILL BE COMMITTING AN OFFENCE WHERE THEY DO SO IN THE KNOWLEDGE, OR WITH REASONABLE CAUSE TO BELIEVE, THAT THE EMPLOYEE IS DISQUALIFIED.**

**Part 4 – Signatures** (please read guidance note 11)

**Signature of applicant or applicant’s solicitor or other duly authorised agent** (see guidance note 12). **If signing on behalf of the applicant, please state in what capacity.**

<b>Declaration</b>	<ul style="list-style-type: none"> <li>[Applicable to individual applicants only, including those in a partnership which is not a limited liability partnership] I understand I am not entitled to be issued with a licence if I do not have the entitlement to live and work in the UK (or if I am subject to a condition preventing me from doing work relating to the carrying on of a licensable activity) and that my licence will become invalid if I cease to be entitled to live and work in the UK (please read guidance note 15).</li> <li>The DPS named in this application form is entitled to work in the UK (and is not subject to conditions preventing him or her from doing work relating to a licensable activity) and I have seen a copy of his or her proof of entitlement to work, or have conducted an online right to work check using the Home Office online right to work checking service which confirmed their right to work (please see note 15)</li> </ul>
Signature	<i>Licensing Law Consultancy</i>
Date	29 October 2021
Capacity	Authorised Agent

**For joint applications, signature of 2<sup>nd</sup> applicant or 2<sup>nd</sup> applicant’s solicitor or other authorised agent** (please read guidance note 13). **If signing on behalf of the applicant, please state in what capacity.**

Signature	
Date	
Capacity	

Contact name (where not previously given) and postal address for correspondence associated with this application (please read guidance note 14)

  
Licensing Law Consultancy  
3 The Triangle  
NG2 Business Park  
Queens Drive

Post town	Nottingham	Postcode	NG2 1AE
Telephone number (if any)	0115 784 3822		
If you would prefer us to correspond with you by e-mail, your e-mail address (optional)			
walaiti.rathore@licensinglawconsultancy.co.uk			

## Notes for Guidance

1. Describe the premises, for example the type of premises, its general situation and layout and any other information which could be relevant to the licensing objectives. Where your application includes off-supplies of alcohol and you intend to provide a place for consumption of these off-supplies, you must include a description of where the place will be and its proximity to the premises.
2. In terms of specific regulated entertainments please note that:
  - Plays: no licence is required for performances between 08:00 and 23.00 on any day, provided that the audience does not exceed 500.
  - Films: no licence is required for 'not-for-profit' film exhibition held in community premises between 08.00 and 23.00 on any day provided that the audience does not exceed 500 and the organiser (a) gets consent to the screening from a person who is responsible for the premises; and (b) ensures that each such screening abides by age classification ratings.
  - Indoor sporting events: no licence is required for performances between 08.00 and 23.00 on any day, provided that the audience does not exceed 1000.
  - Boxing or Wrestling Entertainment: no licence is required for a contest, exhibition or display of Greco-Roman wrestling, or freestyle wrestling between 08.00 and 23.00 on any day, provided that the audience does not exceed 1000. Combined fighting sports – defined as a contest, exhibition or display which

combines boxing or wrestling with one or more martial arts – are licensable as a boxing or wrestling entertainment rather than an indoor sporting event.

- Live music: no licence permission is required for:
  - a performance of unamplified live music between 08.00 and 23.00 on any day, on any premises.
  - a performance of amplified live music between 08.00 and 23.00 on any day on premises authorised to sell alcohol for consumption on those premises, provided that the audience does not exceed 500.
  - a performance of amplified live music between 08.00 and 23.00 on any day, in a workplace that is not licensed to sell alcohol on those premises, provided that the audience does not exceed 500.
  - a performance of amplified live music between 08.00 and 23.00 on any day, in a church hall, village hall, community hall, or other similar community premises, that is not licensed by a premises licence to sell alcohol, provided that (a) the audience does not exceed 500, and (b) the organiser gets consent for the performance from a person who is responsible for the premises.
  - a performance of amplified live music between 08.00 and 23.00 on any day, at the non-residential premises of (i) a local authority, or (ii) a school, or (iii) a hospital, provided that (a) the audience does not exceed 500, and (b) the organiser gets consent for the performance on the relevant premises from: (i) the local authority concerned, or (ii) the school or (iii) the health care provider for the hospital.
- Recorded Music: no licence permission is required for:
  - any playing of recorded music between 08.00 and 23.00 on any day on premises authorised to sell alcohol for consumption on those premises, provided that the audience does not exceed 500.
  - any playing of recorded music between 08.00 and 23.00 on any day, in a church hall, village hall, community hall, or other similar community premises, that is not licensed by a premises licence to sell alcohol, provided that (a) the audience does not exceed 500, and (b) the organiser gets consent for the performance from a person who is responsible for the premises.
  - any playing of recorded music between 08.00 and 23.00 on any day, at the non-residential premises of (i) a local authority, or (ii) a school, or (iii) a hospital, provided that (a) the audience does not exceed 500, and (b) the organiser gets consent for the performance on the relevant premises from: (i) the local authority concerned, or (ii) the school proprietor or (iii) the health care provider for the hospital.
- Dance: no licence is required for performances between 08.00 and 23.00 on any day, provided that the audience does not exceed 500. However, a performance which amounts to adult entertainment remains licensable.
- Cross activity exemptions: no licence is required between 08.00 and 23.00 on any day, with no limit on audience size for:
  - any entertainment taking place on the premises of the local authority where the entertainment is provided by or on behalf of the local authority;
  - any entertainment taking place on the hospital premises of the health care provider where the entertainment is provided by or on behalf of the health care provider;
  - any entertainment taking place on the premises of the school where the entertainment is provided by or on behalf of the school proprietor; and
  - any entertainment (excluding films and a boxing or wrestling entertainment) taking place at a travelling circus, provided that (a) it takes place within a moveable structure that accommodates the audience, and (b) that the travelling circus has not been located on the same site for more than 28 consecutive days.

3. Where taking place in a building or other structure please tick as appropriate (indoors may include a tent).
4. For example the type of activity to be authorised, if not already stated, and give relevant further details, for example (but not exclusively) whether or not music will be amplified or unamplified.
5. For example (but not exclusively), where the activity will occur on additional days during the summer months.
6. For example (but not exclusively), where you wish the activity to go on longer on a particular day e.g. Christmas Eve.
7. Please give timings in 24 hour clock (e.g. 16.00) and only give details for the days of the week when you intend the premises to be used for the activity.
8. If you wish people to be able to consume alcohol on the premises, please tick 'on the premises'. If you wish people to be able to purchase alcohol to consume away from the premises, please tick 'off the premises'. If you wish people to be able to do both, please tick 'both'.
9. Please give information about anything intended to occur at the premises or ancillary to the use of the premises which may give rise to concern in respect of children, regardless of whether you intend children to have access to the premises, for example (but not exclusively) nudity or semi-nudity, films for restricted age groups or the presence of gaming machines.
10. Please list here steps you will take to promote all four licensing objectives together.
11. The application form must be signed.
12. An applicant's agent (for example solicitor) may sign the form on their behalf provided that they have actual authority to do so.
13. Where there is more than one applicant, each of the applicants or their respective agent must sign the application form.
14. This is the address which we shall use to correspond with you about this application.

**15. Entitlement to work/immigration status for individual applicants and applications from partnerships which are not limited liability partnerships:**

A licence may not be held by an individual or an individual in a partnership who is resident in the UK who:

- does not have the right to live and work in the UK; or
- is subject to a condition preventing him or her from doing work relating to the carrying on of a licensable activity.

Any premises licence issued in respect of an application made on or after 6 April 2017 will become invalid if the holder ceases to be entitled to work in the UK.

Applicants must demonstrate that they have an entitlement to work in the UK and are not subject to a condition preventing them from doing work relating to the carrying on of a licensable activity. They do this in one of two ways: 1) by providing with this application copies or scanned copies of the documents listed below (which do not need to be certified), or 2) by providing their 'share code' to enable the licensing authority to carry out a check using the Home Office online right to work checking service (see below).

**Documents which demonstrate entitlement to work in the UK**

- An expired or current passport showing the holder, or a person named in the passport as the child of the holder, is a British citizen or a citizen of the UK and Colonies having the right of abode in the UK [please see note below about which sections of the passport to copy].

- An expired or current passport or national identity card showing the holder, or a person named in the passport as the child of the holder, is a national of a European Economic Area country or Switzerland.
- A Registration Certificate or document certifying permanent residence issued by the Home Office to a national of a European Economic Area country or Switzerland.
- A Permanent Residence Card issued by the Home Office to the family member of a national of a European Economic Area country or Switzerland.
- A **current** Biometric Immigration Document (Biometric Residence Permit) issued by the Home Office to the holder indicating that the person named is allowed to stay indefinitely in the UK, or has no time limit on their stay in the UK.
- A **current** passport endorsed to show that the holder is exempt from immigration control, is allowed to stay indefinitely in the UK, has the right of abode in the UK, or has no time limit on their stay in the UK.
- A **current** Immigration Status Document issued by the Home Office to the holder with an endorsement indicating that the named person is allowed to stay indefinitely in the UK or has no time limit on their stay in the UK, **when produced in combination with** an official document giving the person's permanent National Insurance number and their name issued by a Government agency or a previous employer.
- A birth or adoption certificate issued in the UK, **when produced in combination with** an official document giving the person's permanent National Insurance number and their name issued by a Government agency or a previous employer.
- A birth or adoption certificate issued in the Channel Islands, the Isle of Man or Ireland **when produced in combination with** an official document giving the person's permanent National Insurance number and their name issued by a Government agency or a previous employer.
- A certificate of registration or naturalisation as a British citizen, **when produced in combination with** an official document giving the person's permanent National Insurance number and their name issued by a Government agency or a previous employer.
- A **current** passport endorsed to show that the holder is allowed to stay in the UK and is currently allowed to work and is not subject to a condition preventing the holder from doing work relating to the carrying on of a licensable activity.
- A **current** Biometric Immigration Document (Biometric Residence Permit) issued by the Home Office to the holder which indicates that the named person can currently stay in the UK and is allowed to work relation to the carrying on of a licensable activity.
- A **current** Residence Card issued by the Home Office to a person who is not a national of a European Economic Area state or Switzerland but who is a family member of such a national or who has derivative rights or residence.

- A **current** Immigration Status Document containing a photograph issued by the Home Office to the holder with an endorsement indicating that the named person may stay in the UK, and is allowed to work and is not subject to a condition preventing the holder from doing work relating to the carrying on of a licensable activity **when produced in combination with** an official document giving the person's permanent National Insurance number and their name issued by a Government agency or a previous employer.
- A Certificate of Application, **less than 6 months old**, issued by the Home Office under regulation 18(3) or 20(2) of the Immigration (European Economic Area) Regulations 2016, to a person who is not a national of a European Economic Area state or Switzerland but who is a family member of such a national or who has derivative rights of residence.
- Reasonable evidence that the person has an outstanding application to vary their permission to be in the UK with the Home Office such as the Home Office acknowledgement letter or proof of postage evidence, or reasonable evidence that the person has an appeal or administrative review pending on an immigration decision, such as an appeal or administrative review reference number.
- Reasonable evidence that a person who is not a national of a European Economic Area state or Switzerland but who is a family member of such a national or who has derivative rights of residence in exercising treaty rights in the UK including:
  - evidence of the applicant's own identity – such as a passport,
  - evidence of their relationship with the European Economic Area family member – e.g. a marriage certificate, civil partnership certificate or birth certificate, and
  - evidence that the European Economic Area national has a right of permanent residence in the UK or is one of the following if they have been in the UK for more than 3 months:
    - (i) working e.g. employment contract, wage slips, letter from the employer,
    - (ii) self-employed e.g. contracts, invoices, or audited accounts with a bank,
    - (iii) studying e.g. letter from the school, college or university and evidence of sufficient funds; or
    - (iv) self-sufficient e.g. bank statements.

Family members of European Economic Area nationals who are studying or financially independent must also provide evidence that the European Economic Area national and any family members hold comprehensive sickness insurance in the UK. This can include a private medical insurance policy, an EHIC card or an S1, S2 or S3 form.

**Original documents must not be sent to licensing authorities.** If the document copied is a passport, a copy of the following pages should be provided:

- (i) any page containing the holder's personal details including nationality;
- (ii) any page containing the holder's photograph;
- (iii) any page containing the holder's signature;
- (iv) any page containing the date of expiry; and
- (v) any page containing information indicating the holder has permission to enter or remain in the UK and is permitted to work.

If the document is not a passport, a copy of the whole document should be provided.

Your right to work will be checked as part of your licensing application and this could involve us checking your immigration status with the Home Office. We may otherwise share information with the Home Office. Your licence application will not be determined until you have complied with this guidance.

### **Home Office online right to work checking service**

As an alternative to providing a copy of the documents listed above, applicants may demonstrate their right to work by allowing the licensing authority to carry out a check with the Home Office online right to work checking service.

To demonstrate their right to work via the Home Office online right to work checking service, applicants should include in this application their 9-digit share code (provided to them upon accessing the service at <https://www.gov.uk/prove-right-to-work>) which, along with the applicant's date of birth (provided within this application), will allow the licensing authority to carry out the check.

In order to establish the applicant's right to work, the check will need to indicate that the applicant is allowed to work in the United Kingdom and is not subject to a condition preventing them from doing work relating to the carrying on of a licensable activity.

An online check will not be possible in all circumstances because not all applicants will have an immigration status that can be checked online. The Home Office online right to work checking service sets out what information and/or documentation applicants will need in order to access the service. Applicants who are unable to obtain a share code from the service should submit copy documents as set out above.

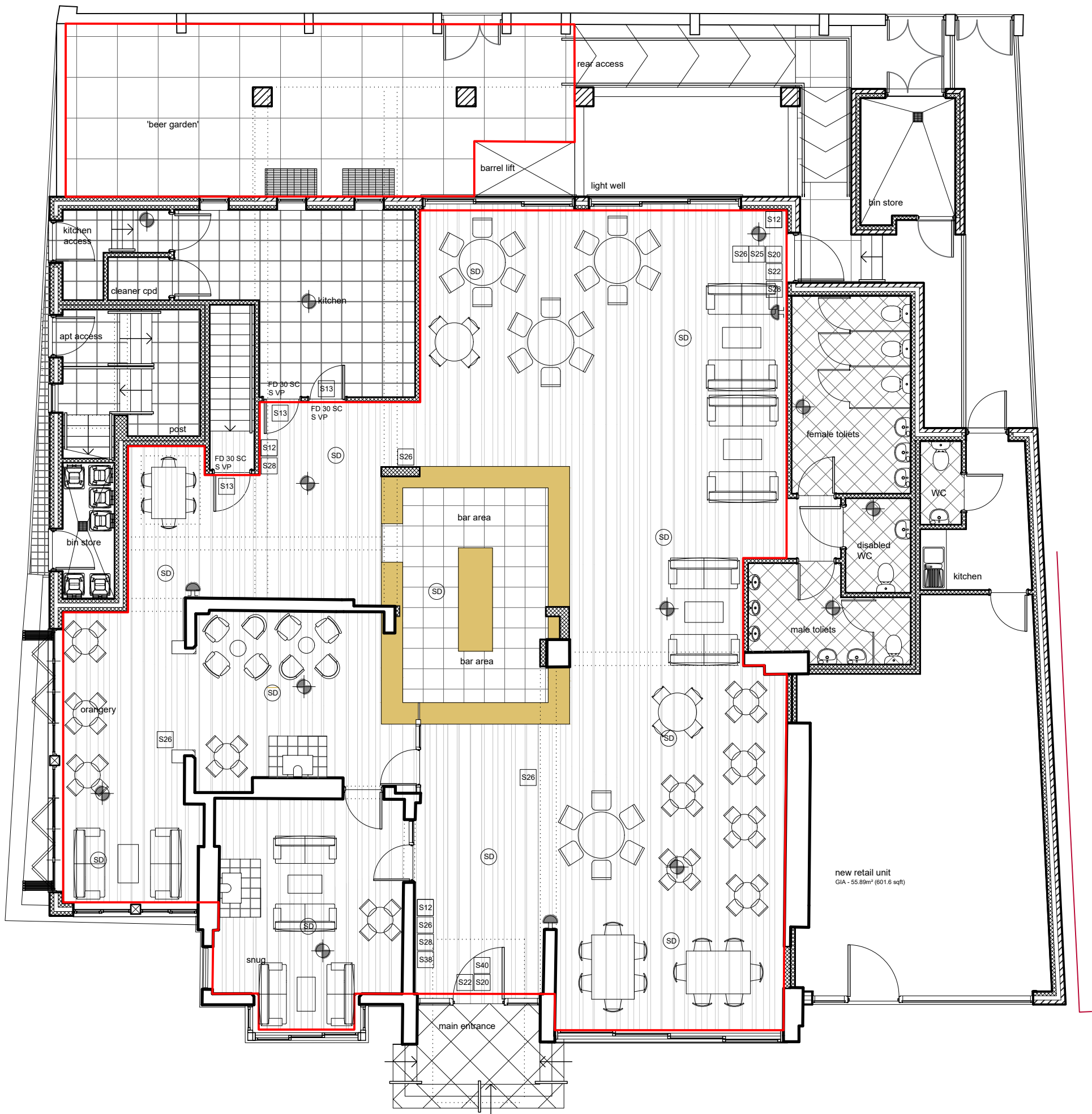

- LEGEND TO FIRE SAFETY SIGNAGE:
- S 12 Fire Action Signs - at extinguishing equipment and call point positions (locations t.b.c.)
  - S 13 Fire Door Keep Shut - all fire doors
  - S 14 Fire Door Keep locked - all store room doors, service cupboards etc (refer to door schedule)
  - S 20 Fire Escape Keep Clear - to all final exit doors externally
  - S 22 Fire Exit- all storey and final exits
  - S 25 Push Bar To Open- all panic bolts (refer to door schedule)
  - S 26 Directional Arrow (green) to direct to final exit or storey exit
  - S 28 Fire Alarm Call Point- all final exits and all stair landings (locations t.b.c. and addressable)
  - S 38 Fire Plan
  - S 40 Sign to read "MIND THE STEP" with 50mm min. high lettering

SD smoke detection    SD optical type  
HD heat detection    HD

FD 30 Fire door  
FD 60 Fire door  
SC - self closer    S - smoke seal.    VP - Vision panel.

emergency lighting   

electronic fire alarm sounder   

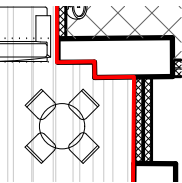

GIA for the bar area - 256.4m<sup>2</sup>  
GEA for the beer garden - 44.91m<sup>2</sup>

red line denotes area used for the supply of alcohol,  
provision of regulated entertainment and late night  
refreshment

bar area

bar furniture added	22.10.21	nh	C
bar area highlighted	15.10.21	nh	B
updated with more fire strategy info	11.10.21	nh	A
Revision	Date	By	No

Nick Hutchings Architect Ltd

J Landa

Lloyds TSB  
31 Plains Rd  
Mapperley, Nottingham. NG3 5JU

licensing floor plan  
441 L 01 C

scale - 1:100    date - October 21  
DRAWN : NH



3

# Objections

---

**From:** Terry Buttle <Terry.Buttle@gedling.gov.uk>  
**Sent:** 26 November 2021 15:28  
**To:** Paul Gibbs <Paul.Gibbs@gedling.gov.uk>; Rachel Pentlow <Rachel.Pentlow@gedling.gov.uk>  
**Cc:** Kevin Nealon <Kevin.Nealon@gedling.gov.uk>  
**Subject:** Licence Application Old Bank Mapperley

Paul

I would like to object to the licence application for the Old Bank 31 Plains Road Mapperley on the Grounds of Public Nuisance.

I have examined the plans submitted and I would like to object to the use of the outside area on the grounds of public nuisance due to the potential noise levels from the use of the outside area as these are likely to cause a public nuisance to nearby residential properties including those properties that have been proposed to the rear and above the premises. The predicted noise levels would exceed the World Health Organisations guidelines for noise inside and outside of residential properties.

Regards

**Terry Buttle**

Environmental Health Officer - *Public Protection Section*

**Gedling Borough Council**

Civic Centre, Arnot Hill Park, Arnold, Nottinghamshire, NG5 6LU

Tel 0115 9013836

## The Old Bank 31 Plains Road

I wish to object to the above application for the use of the outdoor area. As I believe that the noise from this development is likely to cause significant problems to nearby properties. I have calculated the predicted noise levels and the calculations suggest that the predicted noise levels will exceed the World Health Organisations (WHO) guidelines for acceptable levels of noise and is likely to be a statutory nuisance to nearby residents.

### Calculations

In order to calculate the potential noise levels I have used the standard formula for calculating noise attenuation due to distance as follows  $L_p = L_w - 20 \log r - 11$  (B.J. Smith, R.J.Peters and S. Owen)

$L_p$  = predicted sound level

$L_w$  = Sound power level of source

$r$  = distance from noise source.

11 is a variable that depends on the number of reflective surfaces close to the sound source

**N.B.** 11 is used where there is a single hard reflective surface such as the ground, however where the noise source is close to another reflective surface this figure would decrease to allow for the increase in noise levels due reflection of noise from the additional surfaces. Where there are two reflecting surfaces such as a rear wall and the ground this figure would be 8 but where there are three reflecting surfaces such as a in a corner this figure would be 5

Distance to nearest residential property is 30M

Distance to nearest properties garden is 35M

These distances were derived from the Councils mapping system on their database for handling complaints and are shown in figures 1 and 2 below.

Noise levels from pubs and clubs can vary widely, however it has been suggested in (W. J. Davies et al) that noise levels in pubs and clubs can be up to 88dB without music and 95dB with music

Using the above formula and figures this gives us the following predicted noise levels at the nearest property

### Predicted noise levels

Without music

$$L_p = L_w - 20 \log r - 11$$

$$88 - 20 \log 30 - 11 = 47.5 \text{dB}$$

With music

$$L_p = L_w - 20 \log r - 11$$

$$95 - 20 \log 30 - 11 = 54.5$$

In the gardens of the nearest property this gives the following predicted noise levels

Without music

$$L_p = L_w - 20 \log r - 11$$
$$88 - 20 \log 35 - 11 = 47 \text{dB}$$

With music

$$L_p = L_w - 20 \log r - 11$$
$$95 - 20 \log 35 - 11 = 54 \text{dB}$$

The above figures are based on the standard formula that assumes there are no other reflective surfaces other than the ground, however it is possible that the noise levels could be higher than these if the noise is being reflected by a rear wall for example then the predicted noise levels would be as follows. With an additional reflective surface the formula becomes  $L_p = L_w - 20 \log r - 8$  which would lead to an increase in noise levels of 3dB as follows

At nearest property

Without music 50.5dB With Music 57.5dB

In Garden of nearest property

Without music 50dB with music 57dB

### **Guidelines for noise levels**

The World Health Organisation (WHO) guidelines on what may be considered acceptable noise levels suggest the following noise levels (Berglund, Lindvall and Schwela 2018)

Outdoor living areas

55dB serious annoyance

50dB moderate annoyance

Outside Bedrooms

Sleep disturbance with window open 45dB

### **Summary**

The above calculations suggest that the noise levels at the nearest property could be 57dB at the nearest residential property which has windows that face the proposed development and that this is higher than the level at which the WHO suggest that disturbance to sleep would occur. Even the more conservative predictions would exceed the WHO Guidelines for the disturbance of sleep.

These are the calculated noise levels for the nearest residential property, however it has been proposed that as part of the development of the site there will be apartments on the first and second floors of the building above, so the noise levels from the outside area at these premises will be significantly higher than those above.

Furthermore even in the best managed and well regulated pubs and bars it is difficult to regulate the volume of customers themselves and as the evening progresses and people become more relaxed they can become more vocal and increase in volume which would further exacerbate any noise issues.

## References

B.J. Smith, R.J. Peters and S. Owen: *Acoustics and Noise Control 2<sup>nd</sup> Edition* 1996 Addison Wesley, Longman Ltd .

W.J. Davies, P Hepworth, A. Moorhouse and R. Oldfield: *Noise from Pubs and Clubs Final Report*. University of Salford. 2005

Birgitta Berglund, Thomas Lindvall and Dietrich H Schwela *Guidelines for Community Noise*. Accessed at <https://www.who.int/docstore/peh/noise/Comnoise-1.pdf> on 22 December 2020

## Additional Information

### Maps showing distances

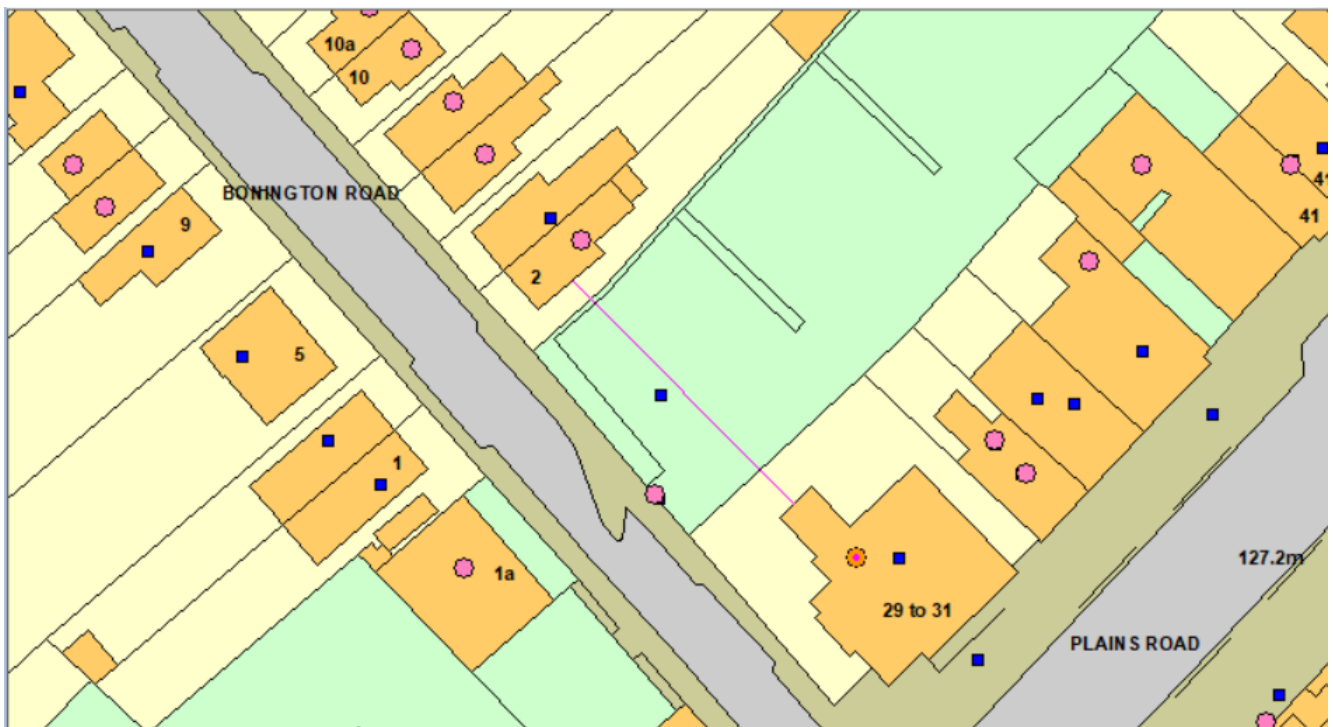

Fig 1 showing distance of 30m to nearest residential property

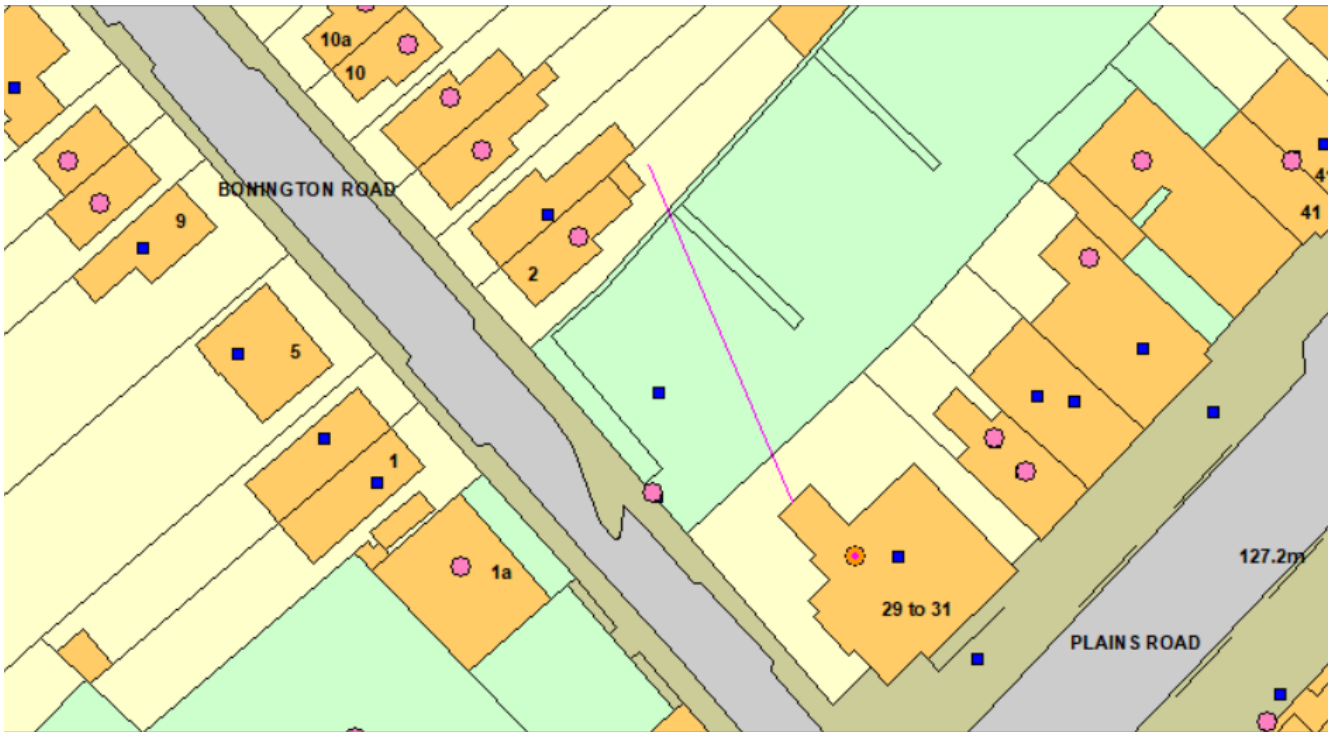

Fig 2 showing distance of 35m to garden of nearest property

## Licensing Act 2003 Licensing Representation Form

If you wish you can use this form to make your representation to the Licensing Authority.

Representations can be made against a licence application by an interested party. Representations may also be made on behalf of an interested party by a representative e.g. MP, solicitor, or a friend. **Please be mindful that that your representation can be viewed by the Applicant or by a representative of the Applicant. It may also be read out in public at the Licensing Panel hearing.**

(a) **Please indicate in which capacity you are making this representation by ticking a box below:**

- ☒ An individual
- ☐ A business
- ☐ A person representing the individual(s)/business(es)
- ☐ A body representing the individual(s)/business(es)

**Representations are only relevant to an application if they relate to at least one of the four Licensing Objectives listed below:**

- 1. The Prevention of Crime and Disorder**
- 2. Public Safety**
- 3. Prevention of Public Nuisance**
- 4. The Protection of Children from Harm**

Representations may be made at any time during a period of **28 consecutive days** starting on the day after the application was given to the Licensing Authority. In the case of a closure order issued by the Police, representations may be made during the seven days that follow relevant notice being given to the Local Authority by the Magistrates Court, starting on the day after the day the notice was received.

**(b) Please enter contact details of interested party below:**

Name: Tom Price .....

Address: 17 Bonington Road, Mapperley, Nottingham .....

Postcode: NG3 5JR .....

Telephone number (optional): [REDACTED] .....

E-mail (optional): [REDACTED] .....

**(c) Please confirm name and address of person or business affected if different from the address given above:**

Name: .....

Address: .....

Postcode: .....

**(d) Please provide details of the application to which you wish to make a representation.**

Name of Applicant: Old Bank Mapperley Ltd .....

Address of Premises: 31 Plains Road, Mapperley, Nottingham .....

Application for: Premises License to sell alcohol til 2am .....



**Details of your representation** (please ensure relevance to the above licensing objectives):

I would like to object in the strongest possible terms to the proposed application to allow the proposed development at 31 Plains Road to sell alcohol until 2am every night of the week, or indeed any night of the week. The site is at the top of a quiet residential road with many families with young children. Having what is effectively proposed to be a nightclub at the top of the road is absolutely unacceptable. Bonington Road will undoubtedly be used as a route to and from the site, with people spilling out at 2am after a night of drinking, the resulting noise and potential for anti-social behaviour in the middle of the night will, without question, cause disruption and concern for families on the street.

The disruption at the end of the night is not the only aspect to which I would like to object, also the noise from the venue itself until the early hours will be heard quite clearly on Bonington Road as the site is so near to the houses.

Not one other licensed premises on Mapperley Top has a licence til 2am and it is my sincere hope that the site at 31 Plains Road will not be the first.

(Please continue on separate sheet if necessary)

(e) Please indicate which of the Licensing Objectives your representation refers to by ticking the relevant box(es) below:

☒ The Prevention of Crime and Disorder

☐ Public Safety

☒ Prevention of Public Nuisance

☐ The Protection of Children from Harm

(f) Suggest alternatives

If possible please suggest alterations to the application, or conditions that would resolve the problem mentioned above, again paying attention to the licensing objectives.

As an alternative to the proposed 2am closing time I would suggest timings more in keeping with other licensed premises in the area and any noise from loud music or otherwise be kept to an enforceable level which is not disturbing to the residents of Bonington Road.

Once the Licensing Section has received this form you will receive a written acknowledgment and you may be contacted to discuss the issue prior to any referral to a Licensing Panel hearing.

☐ Please tick this box if you do not intend to attend or be represented at any hearing. This means that only your written representation will be able to be considered.

If you wish to withdraw any representations you may do so confirming this in writing to the address given below, providing you do so no later than 24 hours before the any hearing, or otherwise orally at the hearing.

Signed  .....

PRINT NAME: Thomas Price .....

Date: 9/11/2021 .....

Please now return this completed form to the following address:

**Licensing Section  
Public Protection  
Gedling Borough Council  
Civic Centre  
Arnot Hill Park  
Arnold  
Nottingham NG5 6LU**

### **Privacy Statement**

The information regarding the Councils Privacy Policy can be found at:  
[www.gedling.gov.uk/Licensing-privacy](http://www.gedling.gov.uk/Licensing-privacy)

RECEIVED

10 NOV 2021

Michael + Rosemary Sanders  
60 Steedman Avenue  
Mapperley Nottingham  
NG3 6DL

9<sup>th</sup> Nov 2021

Dear Sirs

I read of the proposed  
Licensing application for the  
plans for the TSB Bank to  
be a venue opened every  
day till 2am. I cannot believe

it even being considered.  
For a start private residential  
homes far too near.

Also Mapperley top already  
3 pubs 2 micro bars next to  
each other, 6 bars-restaurant.

Everyone we have spoken to is  
appalled at the idea of one  
being opened 7 days a week  
till 2am. Think of the disturbance  
the noise. Are not the plans for  
top floor of TSB to be apartments?  
Disturbing for them.

Mapperley is a residential area  
this proposal is not suitable

Sincerely



**From:**  
**To:**  
**Subject:**  
**Date:** FW: Proposed licensing application  
**Importance:** 09 November 2021 12:06:00 High

---

-----Original Message-----

From: Rosemary Sanders [REDACTED]  
Sent: 09 November 2021 10:17  
To: Enquiries <Enquiries@gedling.gov.uk>  
Subject: Proposed licensing application

Sirs, I am greatly concerned about the proposed application for the old TSB site becoming a entertainment centre/ restaurant / bar open 7 days a a week till 2am, Mapperley top is already flooded with bars /pubs / restaurants but can't understand one open till those hours even being considered in a residential area, houses are far too near ,just think of the disturbance, the noise to residents . I also heard the top floor was going to be apartments , not suitable for those residents.

Mapperley is already becoming a less desired area to live this proposal would be the last straw. Along  
with many many others we are greatly concernned. Sincerely Michael& Rosemary  
Sanders 6b,Steedman Avenue NG3 6 DL



RECEIVED

9 JUL 2021

## Licensing Act 2003 Licensing Representation Form

If you wish you can use this form to make your representation to the Licensing Authority.

Representations can be made against a licence application by an interested party. Representations may also be made on behalf of an interested party by a representative e.g. MP, solicitor, or a friend. **Please be mindful that that your representation can be viewed by the Applicant or by a representative of the Applicant. It may also be read out in public at the Licensing Panel hearing.**

(a) **Please indicate in which capacity you are making this representation by ticking a box below:**

☒ An individual

☐ A business

☐ A person representing the individual(s)/business(es)

☐ A body representing the individual(s)/business(es)

**Representations are only relevant to an application if they relate to at least one of the four Licensing Objectives listed below:**

1. The Prevention of Crime and Disorder
2. Public Safety
3. Prevention of Public Nuisance
4. The Protection of Children from Harm

Representations may be made at any time during a period of **28 consecutive days** starting on the day after the application was given to the Licensing Authority. In the case of a closure order issued by the Police, representations may be made during the seven days that follow relevant notice being given to the Local Authority by the Magistrates Court, starting on the day after the day the notice was received.

(b) Please enter contact details of interested party below:

Name: Lynda... Schippers.....

Address: 13... Bonington Road, Mapperley... Notts.....

Postcode: NG3... 5JR.....

Telephone number (optional): [REDACTED]...

E-mail (optional): [REDACTED]

(c) Please confirm name and address of person or business affected if different from the address given above:

Name:.....

Address: .....

Postcode: .....

(d) Please provide details of the application to which you wish to make a representation.

Name of Applicant: Old Bank Mapperley Ltd.....

Address of Premises: 31... Plains Road, Mapperley Notts... NG3 5JU

Application for Provision of late night refreshment Monday -  
Sunday 23-00hrs - 02-00hrs.

Opening of premises Mon - Sunday 06-00hrs  
until 02-30hrs

**Details of your representation** (please ensure relevance to the above licensing objectives):

The site of the premises is at the top of Bonington Road which is a very quiet, and peaceful place. We have a strong community spirit and a venue such as this! The old Mapperley Bank is nothing but alarming.

There is no other venue, restaurant, pub or bar that serves alcohol past 1am, and this is The Mapperley Top on Friday and Saturday nights.

This is away from quiet residential homes. Plus as I understand they do not have music.

We have 12 restaurants, pubs & bars in Mapperley. The majority close at 12 midnight at the weekend and 11pm during the week. There is no demand for 2am closing.

The issues I have with a 2am licence is:

Noise from the venue, especially if there will be bifold doors for the warmer weather.

People leaving at all hours and walking down/driving down our quiet road.

Taxis coming and going all night to the top of the road and in the car park at the rear.

The effects of alcohol on customers who may be drinking for many hours.

Attracting the wrong kind of customers for an area such as ours.

Value of our property will fall.

(Please continue on separate sheet if necessary)



(e) Please indicate which of the Licensing Objectives your representation refers to by ticking the relevant box(es) below:

☒ The Prevention of Crime and Disorder

☒ Public Safety

☒ Prevention of Public Nuisance

☐ The Protection of Children from Harm

(f) Suggest alternatives

If possible please suggest alterations to the application, or conditions that would resolve the problem mentioned above, again paying attention to the licensing objectives.

No licence to be granted past 12.30am.

No bifold doors/windows.

Soundproof to keep the noise in for the good of our road and the residents of the 6 new flats above "The old Mapperley Bank"

Parking bay at the side of The old Mapperley Bank to be made residents parking only like the rest of the road.

Taxis to pick up on Woodborough Rd only.

Doorman/lady to stop unwelcome activity

Noise to be stopped such as glass bottles going into bins. This should be done after 8am

No music at all after 12 midnight live or recording of any kind.

Suggest moving the venue to the City Centre

Once the Licensing Section has received this form you will receive a written acknowledgment and you may be contacted to discuss the issue prior to any referral to a Licensing Panel hearing.

☒ Please tick this box if you do not intend to attend or be represented at any hearing. This means that only your written representation will be able to be considered.

If you wish to withdraw any representations you may do so confirming this in writing to the address given below, providing you do so no later than 24 hours before the any hearing, or otherwise orally at the hearing.

Signed: 

PRINT NAME: L. S. SCHIPPERS

Date: 7<sup>th</sup> November 2021

Please now return this completed form to the following address:

**Licensing Section  
Public Protection  
Gedling Borough Council  
Civic Centre  
Arnot Hill Park  
Arnold  
Nottingham NG5 6LU**

#### **Privacy Statement**

The information regarding the Councils Privacy Policy can be found at:  
[www.gedling.gov.uk/Licensing-privacy](http://www.gedling.gov.uk/Licensing-privacy)

# The 12 venues on Mapperley Top and their closing times

C = closed.

M T W T F S S

Blues Dawg - BAR.

C - C - C - 11 - 11 - 11 - 10

Bombay - RESTAURANT.

11 - 11 - 11 - 11 - 11 - 11 - 11

Bread and Bitter - PUB

11 - 11 - 11 - 12 - 12 - 12 - 11

Chungs - RESTAURANT

11 - 11 - 11 - 11 - 11 - 11 - 10<sup>30</sup>

Copper - RESTAURANT/BAR

10<sup>30</sup> - 11 - 11 - 11 - 12<sup>30</sup> - 12<sup>30</sup> - 11

Flower Shop - RESTAURANT/BAR

10<sup>30</sup> - 10<sup>30</sup> - 10<sup>30</sup> - 11 - 12<sup>30</sup> - 12<sup>30</sup> - 10<sup>30</sup>

Passage to India RESTAURANT

10 - 10 - 10 - 10 - 10<sup>30</sup> - 10<sup>30</sup> - 8

Plainsman - RESTAURANT/BAR

11 - 11 - 11 - 11 - 12 - 12 - 10

Tamasha - TAPPAS RESTAURANT

8 - 8 - 8 - 8 - 8 - 8 - 8

Wine Room - Bar

12 - 12 - 12 - 12 - 12 - 12 - 12.

closes sooner when not busy

Woodthorpe Top. (Wetherspoons)

12 - 12 - 12 - 12 - 1 - 1 - 12

Not any close after 1am.

The one that does is only Friday & Sat  
plus is not at the end of a  
quiet road.



**Licensing Act 2003  
Licensing Representation Form**

RECEIVED

9 NOV 2021

If you wish you can use this form to make your representation to the Licensing Authority.

Representations can be made against a licence application by an interested party. Representations may also be made on behalf of an interested party by a representative e.g. MP, solicitor, or a friend. **Please be mindful that that your representation can be viewed by the Applicant or by a representative of the Applicant. It may also be read out in public at the Licensing Panel hearing.**

(a) **Please indicate in which capacity you are making this representation by ticking a box below:**

- ☒ An individual
- ☐ A business
- ☐ A person representing the individual(s)/business(es)
- ☐ A body representing the individual(s)/business(es)

**Representations are only relevant to an application if they relate to at least one of the four Licensing Objectives listed below:**

- 1. The Prevention of Crime and Disorder**
- 2. Public Safety**
- 3. Prevention of Public Nuisance**
- 4. The Protection of Children from Harm**

Representations may be made at any time during a period of **28 consecutive days** starting on the day after the application was given to the Licensing Authority. In the case of a closure order issued by the Police, representations may be made during the seven days that follow relevant notice being given to the Local Authority by the Magistrates Court, starting on the day after the day the notice was received.

(b) Please enter contact details of interested party below:

Name: Laurence McNally  
Address: 21, Bonington Road, Mapperley, Nottingham.  
Postcode: NG3 5JR.

Telephone number (optional):

E-mail (optional):

(c) Please confirm name and address of person or business affected if different from the address given above:

Name: .....

Address: .....

Postcode: .....

(d) Please provide details of the application to which you wish to make a representation.

Name of Applicant: The Old Bank Mapperley Ltd.

Address of Premises: The Old Bank Mapperley, 31, Plains Road,  
NG3 5JU

Application for: .....

- To permit the supply of alcohol and regulated entertainment for 08:00 to 02:00 on Monday to Sundays;
- To provide late night refreshments from 23:00 to 02:00 on Monday to Sundays;
- To provide licensable activities on specific occasions.

Details of your representation (please ensure relevance to the above licensing objectives):

### • Prevention of Crime and Disorder

If alcohol license/refreshment license granted until 2am every night, the premises will attract customers wishing to carry on drinking after normal pub closing times. Premises is at the top of a residential street, Borington Road; problems are inevitable.

### • Prevention of Public Nuisance

• Noise: extremely close to residential properties on Borington Road. Entertainment license would cause significant disturbance to residents especially those who reside at the top of Borington Road many of whom have children (age range 1 year old to mid-teens). The late alcohol license/refreshment license would similarly result in excessive, unacceptable noise particularly when premises would be closing. Cars parked by customers and taxi pick ups would similarly cause unacceptable levels of noise and potentially disorder. (PTO)

### • Protection of Children from Harm

As mentioned above proximity to residential properties with children would almost certainly result in children (and adults) having sleep disturbed on seven days per week.

(Please continue on separate sheet if necessary)

Another consideration would be the problem of vehicles accessing and leaving car park via Bonington Road which is clearly signposted as ~~a residents only~~ access only for residents.

(e) Please indicate which of the Licensing Objectives your representation refers to by ticking the relevant box(es) below:

☒ The Prevention of Crime and Disorder

☐ Public Safety

☒ Prevention of Public Nuisance

☒ The Protection of Children from Harm

(f) Suggest alternatives

If possible please suggest alterations to the application, or conditions that would resolve the problem mentioned above, again paying attention to the licensing objectives.

Prevention of Crime and Disorder

~~If alcohol license/refreshments granted until 2am every night, the premises will attract instances after pub closing times. Premises is at top of a residential street: Benington Road. Problems are inevitable.~~

I have no objection to the premises being a restaurant. However, closing time should be earlier to reflect the proximity to residents on Benington Road. 11pm would be reasonable in my view. Similar premises opposite the proposed premises close at 10:30pm apart from at weekends (Friday and Saturday) when closing time is 12:30. As proposed premises is much closer to residential properties an earlier closing time indicated above (11pm)

Seems reasonable. Music or similar entertainment should cease earlier than closing time to facilitate the aforementioned closing times.



Once the Licensing Section has received this form you will receive a written acknowledgment and you may be contacted to discuss the issue prior to any referral to a Licensing Panel hearing.

☒ Please tick this box if you do not intend to attend or be represented at any hearing. This means that only your written representation will be able to be considered.

If you wish to withdraw any representations you may do so confirming this in writing to the address given below, providing you do so no later than 24 hours before the any hearing, or otherwise orally at the hearing.

Signed

PRINT NAME:

LAURENCE McNALLY

Date:

6th November 2021.

Please now return this completed form to the following address:

**Licensing Section  
Public Protection  
Gedling Borough Council  
Civic Centre  
Arnot Hill Park  
Arnold  
Nottingham NG5 6LU**

#### **Privacy Statement**

The information regarding the Councils Privacy Policy can be found at:  
[www.gedling.gov.uk/Licensing-privacy](http://www.gedling.gov.uk/Licensing-privacy)



## Licensing Act 2003 Licensing Representation Form

If you wish you can use this form to make your representation to the Licensing Authority.

Representations can be made against a licence application by an interested party. Representations may also be made on behalf of an interested party by a representative e.g. MP, solicitor, or a friend. **Please be mindful that that your representation can be viewed by the Applicant or by a representative of the Applicant. It may also be read out in public at the Licensing Panel hearing.**

(a) Please indicate in which capacity you are making this representation by ticking a box below:



An individual



A business



A person representing the individual(s)/business(es)



A body representing the individual(s)/business(es)

Representations are only relevant to an application if they relate to at least one of the four Licensing Objectives listed below:

1. The Prevention of Crime and Disorder
2. Public Safety
3. Prevention of Public Nuisance
4. The Protection of Children from Harm

Representations may be made at any time during a period of **28 consecutive days** starting on the day after the application was given to the Licensing Authority. In the case of a closure order issued by the Police, representations may be made during the seven days that follow relevant notice being given to the Local Authority by the Magistrates Court, starting on the day after the day the notice was received

(b) Please enter contact details of interested party below:

Name: KIRSTIE HINGLEY

Address: 8 SONINGTON RD

Postcode: NG3 5JR

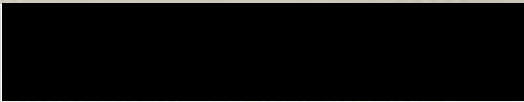
Telephone number (optional): 

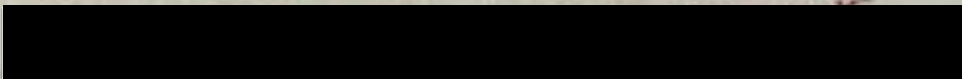
E-mail (optional): 

(c) Please confirm name and address of person or business affected if different from the address given above:

Name: .....

Address: .....

Postcode: .....

(d) Please provide details of the application to which you wish to make a representation.

Name of Applicant: OLD BANK MAPPERLEY LTD

Address of Premises: 31 PLAINS RD, NG3 5JU

Application for: 31 PLAINS RD, NG3 5JU

Details of your representation (please ensure relevance to the above licensing objectives):

PREVENTION OF CRIME + DISORDER &  
PREVENTION OF PUBLIC NUISANCE.

HAVING AN ALCHOL + ENTERTAINMENT  
LICENSE UNTIL 2AM EVERY NIGHT  
CREATES A PROLONGED + LATE  
PERIOD OF DRINKING WHICH WILL  
RESULT IN DISORDER + PUBLIC  
NUISANCE ON A RESIDENTIAL STREET -  
SOWINGTON RD.

(Please continue on separate sheet if necessary)



(e) Please indicate which of the Licensing Objectives your representation refers to by ticking the relevant box(es) below:

☒ The Prevention of Crime and Disorder

☐ Public Safety

☒ Prevention of Public Nuisance

☐ The Protection of Children from Harm

(f) Suggest alternatives

If possible please suggest alterations to the application, or conditions that would resolve the problem mentioned above, again paying attention to the licensing objectives.

IT'S GREAT TO SEE THIS DEVELOPMENT  
IN OUR AREA - BUT AN EARLIER  
LICENSE SEEMS MORE REASONABLE  
IN TERMS OF MINIMISING  
DISORDER + PUBLIC NUISANCE ON  
THE RESIDENTIAL STREET.

Once the Licensing Section has received this form you will receive a written acknowledgment and you may be contacted to discuss the issue prior to any referral to a Licensing Panel hearing.

☐ Please tick this box if you do not intend to attend or be represented at any hearing. This means that only your written representation will be able to be considered.

If you wish to withdraw any representations you may do so confirming this in writing to the address given below, providing you do so no later than 24 hours before the any hearing, or otherwise orally at the hearing.

Signed: 

PRINT NAME: K. HINGLEY

Date: 3.11.21

Please now return this completed form to the following address:

Licensing Section  
Public Protection  
Gedling Borough Council  
Civic Centre  
Arnot Hill Park  
Arnold  
Nottingham NG5 6LU

#### Privacy Statement

The information regarding the Councils Privacy Policy can be found at:  
[www.gedling.gov.uk/Licensing-privacy](http://www.gedling.gov.uk/Licensing-privacy)



## Licensing Act 2003 Licensing Representation Form

If you wish you can use this form to make your representation to the Licensing Authority.

Representations can be made against a licence application by an interested party. Representations may also be made on behalf of an interested party by a representative e.g. MP, solicitor, or a friend. **Please be mindful that that your representation can be viewed by the Applicant or by a representative of the Applicant. It may also be read out in public at the Licensing Panel hearing.**

(a) **Please indicate in which capacity you are making this representation by ticking a box below:**

☒ An individual

☐ A business

☐ A person representing the individual(s)/business(es)

☐ A body representing the individual(s)/business(es)

**Representations are only relevant to an application if they relate to at least one of the four Licensing Objectives listed below:**

- 1. The Prevention of Crime and Disorder**
- 2. Public Safety**
- 3. Prevention of Public Nuisance**
- 4. The Protection of Children from Harm**

Representations may be made at any time during a period of **28 consecutive days** starting on the day after the application was given to the Licensing Authority. In the case of a closure order issued by the Police, representations may be made during the seven days that follow relevant notice being given to the Local Authority by the Magistrates Court, starting on the day after the day the notice was received.



(b) Please enter contact details of interested party below:

Name: Mrs Katy White

Address: 1 BONINGTON ROAD, MAPPERLEY, NOTTS

Postcode: NG3 5JR

Telephone number (optional):

E-mail (optional):

(c) Please confirm name and address of person or business affected if different from the address given above:

Name:

Address:

Postcode:

(d) Please provide details of the application to which you wish to make a representation.

Name of Applicant: OLD BANK MAPPERLEY LTD

Address of Premises: 31 PLAINS ROAD, MAPPERLEY

Application for: A PREMISES LICENCE



**Details of your representation** (please ensure relevance to the above licensing objectives):

I and my family would like to object to the licence application on the grounds that the premises is just too close to a residential area to be open till 2am. The selling of alcohol till this time poses the risk of anti-social behaviour, noise pollution, potential criminal damage to cars or properties close by.

From my home I can see the rear of 31 Plains Road and do not relish the thought of having a view of the beer garden / smoking area and the disturbance this will bring with noise.

There are no other bars in Mapperley that stay open that late. This could potentially mean a gathering from the other bars / pubs to this one establishment meaning a greater risk of noise pollution etc. (Public nuisance, the prevention of Crime and Disorder)

~~Many~~ Many thanks for considering this objection.

(Please continue on separate sheet if necessary)



(e) Please indicate which of the Licensing Objectives your representation refers to by ticking the relevant box(es) below:

☒ The Prevention of Crime and Disorder

☐ Public Safety

☒ Prevention of Public Nuisance

☐ The Protection of Children from Harm

(f) Suggest alternatives

If possible please suggest alterations to the application, or conditions that would resolve the problem mentioned above, again paying attention to the licensing objectives.

The possibility of another independant restaurant in the local area is good news. Therefore the only fair alteration to the application would be for the opening hours to fall in line with the other restaurants, such as Copper, Bombay, Old flower Shop.



Once the Licensing Section has received this form you will receive a written acknowledgment and you may be contacted to discuss the issue prior to any referral to a Licensing Panel hearing.



Please tick this box if you do not intend to attend or be represented at any hearing. This means that only your written representation will be able to be considered.

If you wish to withdraw any representations you may do so confirming this in writing to the address given below, providing you do so no later than 24 hours before the any hearing, or otherwise orally at the hearing.

Signed:

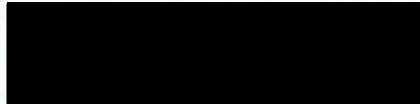

PRINT NAME:

Katy White

Date:

6<sup>th</sup> November 2021

Please now return this completed form to the following address:

Licensing Section  
Public Protection  
Gedling Borough Council  
Civic Centre  
Arnot Hill Park  
Arnold  
Nottingham NG5 6LU

#### Privacy Statement

The information regarding the Councils Privacy Policy can be found at:  
[www.gedling.gov.uk/Licensing-privacy](http://www.gedling.gov.uk/Licensing-privacy)

## Licensing Act 2003 Licensing Representation Form

If you wish you can use this form to make your representation to the Licensing Authority.

Representations can be made against a licence application by an interested party. Representations may also be made on behalf of an interested party by a representative e.g. MP, solicitor, or a friend. **Please be mindful that that your representation can be viewed by the Applicant or by a representative of the Applicant. It may also be read out in public at the Licensing Panel hearing.**

(a) **Please indicate in which capacity you are making this representation by ticking a box below:**

☒

An individual

☐

A business

☐

A person representing the individual(s)/business(es)

☐

A body representing the individual(s)/business(es)

**Representations are only relevant to an application if they relate to at least one of the four Licensing Objectives listed below:**

- 1. The Prevention of Crime and Disorder**
- 2. Public Safety**
- 3. Prevention of Public Nuisance**
- 4. The Protection of Children from Harm**

Representations may be made at any time during a period of **28 consecutive days** starting on the day after the application was given to the Licensing Authority. In the case of a closure order issued by the Police, representations may be made during the seven days that follow relevant notice being given to the Local Authority by the Magistrates Court, starting on the day after the day the notice was received.

**(b) Please enter contact details of interested party below:**

Name: JULIE MATHER

Address: 18 BONINGTON RD, MAPPERLEY

Postcode: NG3 5JR

Telephone number (optional):

E-mail (optional)

**(c) Please confirm name and address of person or business affected if different from the address given above:**

Name:

Address:

Postcode:

**(d) Please provide details of the application to which you wish to make a representation.**

Name of Applicant: Enzygo

Address of Premises: 31 Plains Road Mapperley

Application for: Licensed premises → 2am

**Details of your representation** (please ensure relevance to the above licensing objectives):

### Prevention of Public Nuisance.

I live halfway down Buxington Road, about 200yds from the premises. From our bedroom we can hear activity in the bars on Mapperley Top. Not infrequently I am woken by people staggering loudly down our road at closing time. This is bad enough at midnight but utterly unacceptable at 2am.

There can be no reason and I would have thought no demand for such an arrangement. People leaving at 2am in a highly residential area is simply not fair on anyone living nearby. It may attract a completely different type of customer too which would also have other potential implications in terms of crime & disorder. Ordinary law-abiding people are not in bars until 2am in the week.

(Please continue on separate sheet if necessary)



(e) Please indicate which of the Licensing Objectives your representation refers to by ticking the relevant box(es) below:

☐ The Prevention of Crime and Disorder

☐ Public Safety

☒ Prevention of Public Nuisance

☐ The Protection of Children from Harm

(f) Suggest alternatives

If possible please suggest alterations to the application, or conditions that would resolve the problem mentioned above, again paying attention to the licensing objectives.

12 am at weekends. 11pm  
in the week - This would  
be perfectly adequate.

Once the Licensing Section has received this form you will receive a written acknowledgment and you may be contacted to discuss the issue prior to any referral to a Licensing Panel hearing.

☒ Please tick this box if you do not intend to attend or be represented at any hearing. This means that only your written representation will be able to be considered.

If you wish to withdraw any representations you may do so confirming this in writing to the address given below, providing you do so no later than 24 hours before the any hearing, or otherwise orally at the hearing.

Signe  .....

PRINT NAME: JULIE MATHER .....

Date: 7/11/21 .....

Please now return this completed form to the following address:

**Licensing Section  
Public Protection  
Gedling Borough Council  
Civic Centre  
Arnot Hill Park  
Arnold  
Nottingham NG5 6LU**

#### **Privacy Statement**

The information regarding the Councils Privacy Policy can be found at:  
[www.gedling.gov.uk/Licensing-privacy](http://www.gedling.gov.uk/Licensing-privacy)





- 9 MAY 2021

## Licensing Act 2003 Licensing Representation Form

If you wish you can use this form to make your representation to the Licensing Authority.

Representations can be made against a licence application by an interested party. Representations may also be made on behalf of an interested party by a representative e.g. MP, solicitor, or a friend. **Please be mindful that that your representation can be viewed by the Applicant or by a representative of the Applicant. It may also be read out in public at the Licensing Panel hearing.**

(a) Please indicate in which capacity you are making this representation by ticking a box below:

☒

An individual

☐

A business

☐

A person representing the individual(s)/business(es)

☐

A body representing the individual(s)/business(es)

**Representations are only relevant to an application if they relate to at least one of the four Licensing Objectives listed below:**

1. The Prevention of Crime and Disorder
2. Public Safety
3. Prevention of Public Nuisance
4. The Protection of Children from Harm

Representations may be made at any time during a period of **28 consecutive days** starting on the day after the application was given to the Licensing Authority. In the case of a closure order issued by the Police, representations may be made during the seven days that follow relevant notice being given to the Local Authority by the Magistrates Court, starting on the day after the day the notice was received.

(b) Please enter contact details of interested party below:

Name: Julie Gamble (& Stephen Stapleton)

Address: 16 Bonington Rd, Mapperley

Postcode: NG3 5JR

Telephone number (optional): ..

E-mail (optional): .....

(c) Please confirm name and address of person or business affected if different from the address given above:

Name: .....

Address: .....

Postcode: .....

(d) Please provide details of the application to which you wish to make a representation.

Name of Applicant: Old Bank Mapperley Ltd

Address of Premises: 31 Plains Rd, Mapperley NG3 5JU

Application for: Premises Licence

**Details of your representation** (please ensure relevance to the above licensing objectives):

2AM Close seems very late, every night and much later than other Premises in the area, don't really understand the need for such a late licence. So near a residential Street like Bonington Road.

Also some gardens will be overlooked.

(Please continue on separate sheet if necessary)

(e) Please indicate which of the Licensing Objectives your representation refers to by ticking the relevant box(es) below:

☐ The Prevention of Crime and Disorder

☐ Public Safety

☒ Prevention of Public Nuisance

☐ The Protection of Children from Harm

(f) Suggest alternatives

If possible please suggest alterations to the application, or conditions that would resolve the problem mentioned above, again paying attention to the licensing objectives.

licence should be compatible  
with others in the area.

Once the Licensing Section has received this form you will receive a written acknowledgment and you may be contacted to discuss the issue prior to any referral to a Licensing Panel hearing.

☒ Please tick this box if you do not intend to attend or be represented at any hearing. This means that only your written representation will be able to be considered.

If you wish to withdraw any representations you may do so confirming this in writing to the address given below, providing you do so no later than 24 hours before the any hearing, or otherwise orally at the hearing.

Signed: ...

PRINT NAME: ... JUNE M CAMBHE

Date: ... 8/11/21

Please now return this completed form to the following address:

**Licensing Section  
Public Protection  
Gedling Borough Council  
Civic Centre  
Arnot Hill Park  
Arnold  
Nottingham NG5 6LU**

#### **Privacy Statement**

The information regarding the Councils Privacy Policy can be found at:  
[www.gedling.gov.uk/Licensing-privacy](http://www.gedling.gov.uk/Licensing-privacy)

## Licensing Act 2003 Licensing Representation Form

If you wish you can use this form to make your representation to the Licensing Authority.

Representations can be made against a licence application by an interested party. Representations may also be made on behalf of an interested party by a representative e.g. MP, solicitor, or a friend. **Please be mindful that that your representation can be viewed by the Applicant or by a representative of the Applicant. It may also be read out in public at the Licensing Panel hearing.**

(a) Please indicate in which capacity you are making this representation by ticking a box below:

☒ An individual

☐ A business

☐ A person representing the individual(s)/business(es)

☐ A body representing the individual(s)/business(es)

**Representations are only relevant to an application if they relate to at least one of the four Licensing Objectives listed below:**

- 1. The Prevention of Crime and Disorder**
- 2. Public Safety**
- 3. Prevention of Public Nuisance**
- 4. The Protection of Children from Harm**

Representations may be made at any time during a period of **28 consecutive days** starting on the day after the application was given to the Licensing Authority. In the case of a closure order issued by the Police, representations may be made during the seven days that follow relevant notice being given to the Local Authority by the Magistrates Court, starting on the day after the day the notice was received.

(b) **Please enter contact details of interested party below:**

Name: HARRY LAWTON

Address: 19 BONINGTON ROAD

Postcode: NG3 5JR

Telephone number (optional): .....

E-mail (optional): .....

(c) **Please confirm name and address of person or business affected if different from the address given above:**

Name: .....

Address: .....

Postcode: .....

(d) **Please provide details of the application to which you wish to make a representation.**

Name of Applicant: Mr. LANA. HILLCREST PROPERTIES

Address of Premises: 31 Plains Road, WOODTHORPE NG3 5JU

Application for: 4 Apartments, Ground Floor Unit Class E.

**Details of your representation** (please ensure relevance to the above licensing objectives):

1. The granting of a 2 a.m. late licence could create public nuisance, noise and disturbance to local residents on Bonington Road and in the immediate area on Plains Road. Any drunkenness and anti-social behaviour created by the late drinking licence could further contribute to public nuisance.
2. Taxis and other forms of late-night transport will also add to the noise and congestion in the early hours. Parking is very difficult on Bonington Rd and no doubt visitors to the venue will use residents spaces where they are available.  
Parking has always been a difficult issue for residents, and the 4 new apartments will only make it worse, as no extra parking spaces have been included in the plans of Hillcrest Properties.

(Please continue on separate sheet if necessary)



(e) Please indicate which of the Licensing Objectives your representation refers to by ticking the relevant box(es) below:

☒ The Prevention of Crime and Disorder

☐ Public Safety

☒ Prevention of Public Nuisance

☐ The Protection of Children from Harm

(f) Suggest alternatives

If possible please suggest alterations to the application, or conditions that would resolve the problem mentioned above, again paying attention to the licensing objectives.

1. If application is for a bar licence, this should be restricted to 12 a.m. closing at the maximum, since it is in a residential area.
2. Specific, designated parking to be created that will not affect residents of Bonington Rd.
3. Perhaps some bays of the car park on Bonington road could be allocated for new residents in the proposed 4 new apartments.

Whatever decisions are made by you, I think the interests and welfare of the local residents should take priority over the opening of yet another bar/restaurant in Mapperley.

Once the Licensing Section has received this form you will receive a written acknowledgment and you may be contacted to discuss the issue prior to any referral to a Licensing Panel hearing.

☒ Please tick this box if you do not intend to attend or be represented at any hearing. This means that only your written representation will be able to be considered.

If you wish to withdraw any representations you may do so confirming this in writing to the address given below, providing you do so no later than 24 hours before the any hearing, or otherwise orally at the hearing.

Signed:  .....

PRINT NAME: HARRY LAWTON .....

Date: 9/11/21 .....

Please now return this completed form to the following address:

**Licensing Section  
Public Protection  
Gedling Borough Council  
Civic Centre  
Arnot Hill Park  
Arnold  
Nottingham NG5 6LU**

#### **Privacy Statement**

The information regarding the Councils Privacy Policy can be found at:  
[www.gedling.gov.uk/Licensing-privacy](http://www.gedling.gov.uk/Licensing-privacy)

**Licensing Act 2003  
Licensing Representation Form**

If you wish you can use this form to make your representation to the Licensing Authority.

Representations can be made against a licence application by an interested party. Representations may also be made on behalf of an interested party by a representative e.g. MP, solicitor, or a friend. **Please be mindful that that your representation can be viewed by the Applicant or by a representative of the Applicant. It may also be read out in public at the Licensing Panel hearing.**

(a) **Please indicate in which capacity you are making this representation by ticking a box below:**

- ☒ An individual
- ☐ A business
- ☐ A person representing the individual(s)/business(es)
- ☐ A body representing the individual(s)/business(es)

**Representations are only relevant to an application if they relate to at least one of the four Licensing Objectives listed below:**

- 1. The Prevention of Crime and Disorder**
- 2. Public Safety**
- 3. Prevention of Public Nuisance**
- 4. The Protection of Children from Harm**

Representations may be made at any time during a period of **28 consecutive days** starting on the day after the application was given to the Licensing Authority. In the case of a closure order issued by the Police, representations may be made during the seven days that follow relevant notice being given to the Local Authority by the Magistrates Court, starting on the day after the day the notice was received.

**(b) Please enter contact details of interested party below:**

Name: MRS P. J. MAHON

Address: 31, WHITTINGHAM RD, MAPPERLEY NOTTINGHAM

Postcode: NG3 6BJ

Telephone number (optional): .....

E-mail (optional): .....

**(c) Please confirm name and address of person or business affected if different from the address given above:**

Name: MR+MRS SCHIPPERS

Address: 13, BONINGTON ROAD, MAPPERLEY NOTTINGHAM

Postcode: .....

**(d) Please provide details of the application to which you wish to make a representation.**

Name of Applicant: OLD BANK MAPPERLEY LTD

Address of Premises: OLD BANK 31 PLAINS ROAD MAPPERLEY NOTTINGHAM  
NG3 5JU

Application for: SALE OF ALCOHOL MON-SUN 08:00hrs until 02:00hrs

**Details of your representation** (please ensure relevance to the above licensing objectives):

my concern for the residents of Bonington Road particularly but also Lytton Road. I think the hours of the application to 02.00 am is unreasonable in a residential area.

(Please continue on separate sheet if necessary)

(e) Please indicate which of the Licensing Objectives your representation refers to by ticking the relevant box(es) below:

☐ The Prevention of Crime and Disorder

☐ Public Safety

☒ Prevention of Public Nuisance

☐ The Protection of Children from Harm

(f) Suggest alternatives

If possible please suggest alterations to the application, or conditions that would resolve the problem mentioned above, again paying attention to the licensing objectives.

As this is a residential area I think to open for the sale of alcohol until 02:00hrs every day would cause a disturbance to the local residents. The hours could be reduced especially in the week days. I would suggest 12:00 hrs at the weekends would be reasonable and 11:00 in the week. I am particularly concerned for the residents of Bonington and Gretton Road as there is a car park directly behind the Old Bank building running between these two roads giving opportunity for further nuisance. I also understand that there are going to be flats above the Old Bank building so there would also be disturbance and nuisance for the residents of these.

Once the Licensing Section has received this form you will receive a written acknowledgment and you may be contacted to discuss the issue prior to any referral to a Licensing Panel hearing.

☒ Please tick this box if you do not intend to attend or be represented at any hearing. This means that only your written representation will be able to be considered.

If you wish to withdraw any representations you may do so confirming this in writing to the address given below, providing you do so no later than 24 hours before the any hearing, or otherwise orally at the hearing.

Signed: .....  .....

PRINT NAME: MRS. P. J. MAHON .....

Date: 12.11.21 .....

Please now return this completed form to the following address:

**Licensing Section  
Public Protection  
Gedling Borough Council  
Civic Centre  
Arnot Hill Park  
Arnold  
Nottingham NG5 6LU**

#### **Privacy Statement**

The information regarding the Councils Privacy Policy can be found at:

## Licensing Act 2003 Licensing Representation Form

If you wish you can use this form to make your representation to the Licensing Authority.

Representations can be made against a licence application by an interested party. Representations may also be made on behalf of an interested party by a representative e.g. MP, solicitor, or a friend. **Please be mindful that that your representation can be viewed by the Applicant or by a representative of the Applicant. It may also be read out in public at the Licensing Panel hearing.**

(a) **Please indicate in which capacity you are making this representation by ticking a box below:**

☒

An individual

☐

A business

☐

A person representing the individual(s)/business(es)

☐

A body representing the individual(s)/business(es)

**Representations are only relevant to an application if they relate to at least one of the four Licensing Objectives listed below:**

- 1. The Prevention of Crime and Disorder**
- 2. Public Safety**
- 3. Prevention of Public Nuisance**
- 4. The Protection of Children from Harm**

Representations may be made at any time during a period of **28 consecutive days** starting on the day after the application was given to the Licensing Authority. In the case of a closure order issued by the Police, representations may be made during the seven days that follow relevant notice being given to the Local Authority by the Magistrates Court, starting on the day after the day the notice was received.



**(b) Please enter contact details of interested party below:**

Name: ...Sarah Gregorczyk.....

Address: ...34 Bennett Road .....

Postcode: NG3 6BQ.....

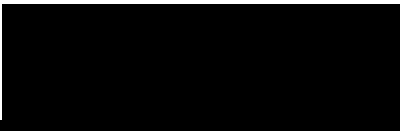
Telephone number (optional): ........

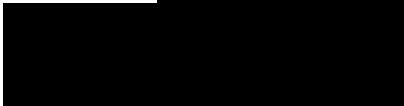
E-mail (optional): ..........

**(c) Please confirm name and address of person or business affected if different from the address given above:**

Name:.....

Address: .....

Postcode: .....

**(d) Please provide details of the application to which you wish to make a representation.**

Name of Applicant: .....Old Bank Mapperley Limited.....

Address of Premises: .....31 Plains Road, Mapperley, Nottingham NG3 5JU

Application for: .....A new premises license.....

**Details of your representation** (please ensure relevance to the above licensing objectives):

There is a new license application for 31 Plains Road Mapperley and I wanted to raise some considerations in relation to this application. We have a number of licensed venues on this Street and they add to the area and apart from issues with 1 location that was inconsiderate of the residential properties close by they have operated responsibly, closing outdoor areas earlier in the evening and keeping exits from the premises to the main road. From what I can tell the premises has no outdoor space but if it does can use of that space be limited to an earlier hour as the property is close to existing residential properties and also can exits from the property be limited to the main road on closing time to keep noise to a minimum for the close by residential properties when people are leaving the venue. A large part of the licensed area appears to be an orangery to the side of the building and this is closer to the residential properties – can there be consideration for noise levels from this area of the property as this looks like it has the potential to interfere with the residential properties on this street if a sensible approach is not taken.

(e) Please indicate which of the Licensing Objectives your representation refers to by ticking the relevant box(es) below:

☐ The Prevention of Crime and Disorder

☐ Public Safety

☒ Prevention of Public Nuisance

☐ The Protection of Children from Harm

(f) Suggest alternatives

If possible please suggest alterations to the application, or conditions that would resolve the problem mentioned above, again paying attention to the licensing objectives.

I am suggesting some stipulations in relation to the license to help prevent problems from occurring with noise from the venue and from people leaving the venue.

So, if there is any outdoor seating to the rear of the property – that this is closed by 9pm so as not to cause a disturbance to local residents as there are houses close to the rear of the venue.

And to limit exit from the venue after 10pm to the front of the venue which is onto the main road and should limit disturbance to local residents.

And for live music and the like to be limited to a sensible hour / location within the venue so has not to cause disturbance to local residents.

Once the Licensing Section has received this form you will receive a written acknowledgment and you may be contacted to discuss the issue prior to any referral to a Licensing Panel hearing.

☒ Please tick this box if you do not intend to attend or be represented at any hearing. This means that only your written representation will be able to be considered.

If you wish to withdraw any representations you may do so confirming this in writing to the address given below, providing you do so no later than 24 hours before the any hearing, or otherwise orally at the hearing.

Signed:  .....

PRINT NAME:.....SARAH GREGORCZYK.....

Date: .....12/11/2021.....

Please now return this completed form to the following address:

**Licensing Section  
Public Protection  
Gedling Borough Council  
Civic Centre  
Arnot Hill Park  
Arnold  
Nottingham NG5 6LU**

### **Privacy Statement**

The information regarding the Councils Privacy Policy can be found at:  
[www.gedling.gov.uk/Licensing-privacy](http://www.gedling.gov.uk/Licensing-privacy)

## Licensing Act 2003 Licensing Representation Form

If you wish you can use this form to make your representation to the Licensing Authority.

Representations can be made against a licence application by an interested party. Representations may also be made on behalf of an interested party by a representative e.g. MP, solicitor, or a friend. **Please be mindful that that your representation can be viewed by the Applicant or by a representative of the Applicant. It may also be read out in public at the Licensing Panel hearing.**

(a) **Please indicate in which capacity you are making this representation by ticking a box below:**



An individual



A business



A person representing the individual(s)/business(es)



A body representing the individual(s)/business(es)

**Representations are only relevant to an application if they relate to at least one of the four Licensing Objectives listed below:**

- 1. The Prevention of Crime and Disorder**
- 2. Public Safety**
- 3. Prevention of Public Nuisance**
- 4. The Protection of Children from Harm**

Representations may be made at any time during a period of **28 consecutive days** starting on the day after the application was given to the Licensing Authority. In the case of a closure order issued by the Police, representations may be made during the seven days that follow relevant notice being given to the Local Authority by the Magistrates Court, starting on the day after the day the notice was received.

**(b) Please enter contact details of interested party below:**

Name: ...David Banton.....

Address: 12 Bonington Road, Mapperley, Nottingham.....

Postcode: ...NG3 5JR.....

Telephone number (optional): [REDACTED] .....

E-mail (optional): ...[REDACTED] .....

**(c) Please confirm name and address of person or business affected if different from the address given above:**

Name:.....

Address: .....

Postcode: .....

**(d) Please provide details of the application to which you wish to make a representation.**

Name of Applicant: Hillcrest Properties Ltd .....

Address of Premises: 31 Plains road, Mapperley, Nottingham, NG3 5JU .....

Application for: ..Planning Application 2021/1141 ..Change of use to provide ..  
restuarant

**Details of your representation** (please ensure relevance to the above licensing objectives):

The applicant Hillcrest has made a planning application to convert the disused TSB bank building at 31 plains road into 6 flats and a restaurant for the sale of food and drink for consumption (mostly) on the premises.

As part of this development Hillcrest is requesting a licence

- to serve alcohol and regulated entertainment between 08:00 and 02:00 Monday to Sunday
- to provide late night refreshment from 23:00 to 02:00 on Monday to Sunday

The Plains road in the area of the proposed development has a number of bars and restaurants in currently in operation,

Wine Bar, Blues Dawg, Flower Pot, Coppers, Topsy T, Plainsman, Woodthorpe top, Bread and Bitter, Bombay, Chuengs, Costa Coffee and the Cake Solution

None of which have a licence to operate until 02:00, the latest is understood to be the Woodthorpe top with a licence until 01:00 on Friday and Saturday. Copper and the Flower shop 12:30 Friday and Saturday night.

This objection is related to the licence request to extend until 02:00, this should be limited to 12:00 Sunday to Thursday and 12:30 Friday and Saturday so as to avoid noise and public nuisance offences that will impact on the lives of the local residents and specifically those living Bonington Road and Gretton Road let alone the future residents of the 6 flats proposed under the scheme as well as being in keeping with the licence hours of the similar businesses in the area.

Mapperley Top is a vibrant local community with a good balance for residences and businesses alike, providing a late night drinking establishment is likely to attract noise, drunk and disorderly behaviour and upset the balance of living in the area and the relationship between residents and business owners.

(Please continue on separate sheet if necessary)

(e) Please indicate which of the Licensing Objectives your representation refers to by ticking the relevant box(es) below:

☒ The Prevention of Crime and Disorder

☒ Public Safety

☒ Prevention of Public Nuisance

☐ The Protection of Children from Harm

(f) Suggest alternatives

If possible please suggest alterations to the application, or conditions that would resolve the problem mentioned above, again paying attention to the licensing objectives.

Limit licence hours to 12:00 Sunday to Thursday and 12:30 Friday and Saturday



Once the Licensing Section has received this form you will receive a written acknowledgment and you may be contacted to discuss the issue prior to any referral to a Licensing Panel hearing.

☐ Please tick this box if you do not intend to attend or be represented at any hearing. This means that only your written representation will be able to be considered.

If you wish to withdraw any representations you may do so confirming this in writing to the address given below, providing you do so no later than 24 hours before the any hearing, or otherwise orally at the hearing.

Signed: .....  
[Redacted Signature]

PRINT NAME:..... David Banton .....

Date: ..... 12th November 2021 .....

Please now return this completed form to the following address:

**Licensing Section  
Public Protection  
Gedling Borough Council  
Civic Centre  
Arnot Hill Park  
Arnold  
Nottingham NG5 6LU**

### **Privacy Statement**

The information regarding the Councils Privacy Policy can be found at:  
[www.gedling.gov.uk/Licensing-privacy](http://www.gedling.gov.uk/Licensing-privacy)

17 DEC 2021



**Licensing Act 2003  
Licensing Representation Form**

If you wish you can use this form to make your representation to the Licensing Authority.

Representations can be made against a licence application by an interested party. Representations may also be made on behalf of an interested party by a representative e.g. MP, solicitor, or a friend. **Please be mindful that that your representation can be viewed by the Applicant or by a representative of the Applicant. It may also be read out in public at the Licensing Panel hearing.**

(a) **Please indicate in which capacity you are making this representation by ticking a box below:**

- ☒ An individual
- ☐ A business
- ☐ A person representing the individual(s)/business(es)
- ☐ A body representing the individual(s)/business(es)

**Representations are only relevant to an application if they relate to at least one of the four Licensing Objectives listed below:**

- 1. The Prevention of Crime and Disorder**
- 2. Public Safety**
- 3. Prevention of Public Nuisance**
- 4. The Protection of Children from Harm**

Representations may be made at any time during a period of **28 consecutive days** starting on the day after the application was given to the Licensing Authority. In the case of a closure order issued by the Police, representations may be made during the seven days that follow relevant notice being given to the Local Authority by the Magistrates Court, starting on the day after the day the notice was received.

(b) Please enter contact details of interested party below:

Name: ALAN K AONE SYMONDS .....

Address: 27, BONINGTON ROAD, WOODTHORPE, NOTTM. ....

Postcode: NG3 5JR .....

Telephone number (optional):

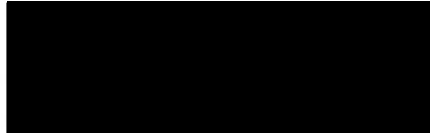

E-mail (optional): .....

(c) Please confirm name and address of person or business affected if different from the address given above:

Name: .....

Address: .....

Postcode: .....

(d) Please provide details of the application to which you wish to make a representation.

Name of Applicant: OLD BANK MAPPERLEY LTD. ....

Address of Premises: 31, PLAINS ROAD, MAPPERLEY, NOTTM. NG3 5JU. ....

Application for: PREMISES LICENSE TO ALLOW ALCOHOL AND  
REGULATED MUSIC WITH REFRESHMENT UNTIL  
2.00 AM. FROM MONDAY TO SUNDAYS, INCLUDING  
LICENSABLE ACTIVITIES ON SPECIFIC OCCASIONS.

**Details of your representation** (please ensure relevance to the above licensing objectives):

PLEASE SEE ATTACHED SHEETS :

(Please continue on separate sheet if necessary)

## **Details of your representation:**

In response to the above 2.00am alcohol and entertainment license application, we write to express our grave concerns for the potential implications of such a license.

Firstly, such late-night entertainment is more appropriately associated with towns or city centres, where the social environment is more conducive, and the infrastructure is in place to serve the needs and implications of the late-night economy.

Although the old TSB bank site sits within the Plains Road shopping hub, the commercial zone is linear in layout, but tightly enclosed by the quiet residential streets of Woodthorpe and Mapperley. The existing and predominantly small businesses, include several bars and restaurants, which operate successfully within reasonable licensed hours of up to 12pm, without adversely affecting the residential neighbourhood. The only exception to this is the 'Woodthorpe Top', which operates until 1.00pm during the weekend and does occasionally lead to minor nuisance due to raised voice levels beyond this time. The late-night extension, however, does not include musical entertainment.

Nevertheless, to grant an Entertainment and Alcohol license to a new business, operating until 2.00 am with live and recorded music, would inevitably lead to nuisance and the potential for disorder close to the residential community.

The existing situation in which businesses successfully operate, ensures that activity and traffic noise reduce gradually during the evening to a point just beyond midnight when the ambient noise levels are normally extremely low. To extend this normal activity period, including live and recorded music for a further 2 to 3 hours, would inevitably cause nuisance by raising noise levels considerably and potentially lead to a range of anti-social activities, associated with excessive alcohol consumption.

In particular, both Gretton and Bonington Roads join Plains Road to either side of the old TSB bank premises and are most likely to suffer the adverse consequences of such nuisance. These roads are occupied by a wide range of residents from families with young children to much more senior residents who will be extremely sensitive to disturbance during the night.

No matter how well managed the new premises may prove to be, there would be increased noise levels from amplified music, which would be accentuated through both ventilating the premises and frequent customer entry/egress. Such increased noise levels could be tolerable during reasonable operating hours, but when ambient noise levels become extremely low, the amplification of such sound would be dramatic.

Additionally, there is the greater potential for nuisance and anti-social behaviour, including disorder, as people start to leave the premises during the early hours of the morning. In particular, between 2.00 and 3.00am, when customers congregate to wait for taxis, most of which will park along the top of Bonington Road or the small municipal car park behind the licensed premises.

In summary, we strongly object to the granting of a Late-night Alcohol and Entertainment License, to the newly converted Old TSB Bank premises, due to the significant risk of

disturbance and potential disorder, immediately adjacent to a long-established and quiet residential area.

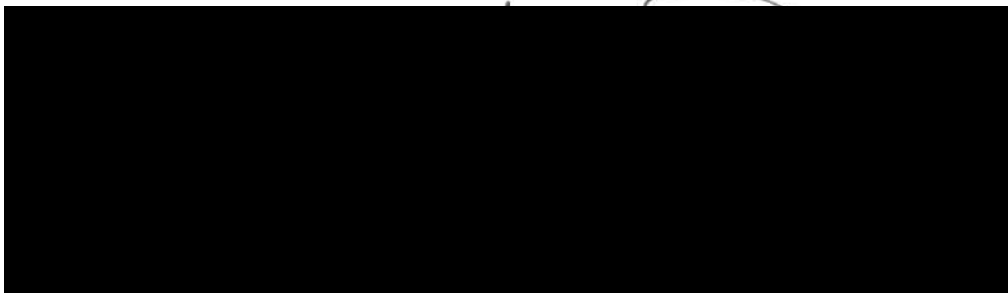

(e) Please indicate which of the Licensing Objectives your representation refers to by ticking the relevant box(es) below:

☒ The Prevention of Crime and Disorder

☐ Public Safety

☒ Prevention of Public Nuisance

☐ The Protection of Children from Harm

(f) Suggest alternatives

If possible please suggest alterations to the application, or conditions that would resolve the problem mentioned above, again paying attention to the licensing objectives.

LICENSE LIMITED TO 12.00 MIDNIGHT.  
ONLY, AS THE ABSOLUTE LATEST.  
TO PREVENT PUBLIC NUISANCE DURING  
ANTI-SOCIAL HOURS AND REDUCE THE  
POTENTIAL FOR DISORDER AND OTHER  
ACTS OF ANTI-SOCIAL BEHAVIOUR, DUE  
TO EXCESSIVE PERIODS OF ALCOHOL CONSUMPTION.

Once the Licensing Section has received this form you will receive a written acknowledgment and you may be contacted to discuss the issue prior to any referral to a Licensing Panel hearing.

☒ Please tick this box if you do not intend to attend or be represented at any hearing. This means that only your written representation will be able to be considered.

If you wish to withdraw any representations you may do so confirming this in writing to the address given below, providing you do so no later than 24 hours before the any hearing, or otherwise orally at the hearing.

Signed:

PRINT NAME: ALAN SYMONDS, ANNE SYMONDS

Date: 14th NOVEMBER 2021

Please now return this completed form to the following address:

Licensing Section  
Public Protection  
Gedling Borough Council  
Civic Centre  
Arnot Hill Park  
Arnold  
Nottingham NG5 6LU

#### Privacy Statement

The information regarding the Councils Privacy Policy can be found at:  
[www.gedling.gov.uk/Licensing-privacy](http://www.gedling.gov.uk/Licensing-privacy)



## Licensing Act 2003 Licensing Representation Form

If you wish you can use this form to make your representation to the Licensing Authority.

Representations can be made against a licence application by an interested party. Representations may also be made on behalf of an interested party by a representative e.g. MP, solicitor, or a friend. **Please be mindful that that your representation can be viewed by the Applicant or by a representative of the Applicant. It may also be read out in public at the Licensing Panel hearing.**

(a) Please indicate in which capacity you are making this representation by ticking a box below:

☒

An individual

☐

A business

☐

A person representing the individual(s)/business(es)

☐

A body representing the individual(s)/business(es)

Representations are only relevant to an application if they relate to at least one of the four Licensing Objectives listed below:

1. The Prevention of Crime and Disorder
2. Public Safety
3. Prevention of Public Nuisance
4. The Protection of Children from Harm

Representations may be made at any time during a period of **28 consecutive days** starting on the day after the application was given to the Licensing Authority. In the case of a closure order issued by the Police, representations may be made during the seven days that follow relevant notice being given to the Local Authority by the Magistrates Court, starting on the day after the day the notice was received.

(b) Please enter contact details of interested party below:

Name: Mark Smaug

Address: 2 Bonington Road

Postcode: NG3 5JR

Telephone number (optional):

E-mail (optional):

(c) Please confirm name and address of person or business affected if different from the address given above:

Name: .....

Address: .....

Postcode: .....

(d) Please provide details of the application to which you wish to make a representation.

Name of Applicant: Old Bank Mapperton Limited

Address of Premises: 31 Pains Road, Mapperton,  
Wittingham, NG3 5JU

Application for: supply of alcohol and regulated  
entertainment from 08:00 to  
02:00 Monday to Sundays  
to provide ~~late~~ late night  
refreshment from 23:00 to  
02:00 Monday to Sunday  
to provide licensable activities  
on specific occasions

Details of your representation (please ensure relevance to the above licensing objectives):

08:00 to 02:00 Sunday  
to Monday is too late  
for a family residential  
area.

During the day Bonington  
Road car park is  
very very busy already.

Parking creates problems  
for residents

Bonington Road is access  
only - many already use  
the road as a cut through.

Smell from the kitchens for  
a 23:00 to 02:00 'late night  
refreshment' will not be nice  
23:00 to 02:00 will create a  
lot of noise

(Please continue on separate sheet if necessary)

(e) Please indicate which of the Licensing Objectives your representation refers to by ticking the relevant box(es) below:

☒ The Prevention of Crime and Disorder

☒ Public Safety

☒ Prevention of Public Nuisance

☐ The Protection of Children from Harm

(f) Suggest alternatives

If possible please suggest alterations to the application, or conditions that would resolve the problem mentioned above, again paying attention to the licensing objectives.

DO NOT GRANT A LICENCE.  
ALCOHOL ONLY WITH FOOD  
UP TO 9 PM  
NO ENTERTAINMENT



Once the Licensing Section has received this form you will receive a written acknowledgment and you may be contacted to discuss the issue prior to any referral to a Licensing Panel hearing.

☐ Please tick this box if you do not intend to attend or be represented at any hearing. This means that only your written representation will be able to be considered.

If you wish to withdraw any representations you may do so confirming this in writing to the address given below, providing you do so no later than 24 hours before the any hearing, or otherwise orally at the hearing.

Signed:  .....

PRINT NAME: MARIE SWANBY .....

Date: 23/11/2021 .....

Please now return this completed form to the following address:

Licensing Section  
Public Protection  
Gedling Borough Council  
Civic Centre  
Arnot Hill Park  
Arnold  
Nottingham NG5 6LU

#### Privacy Statement

The information regarding the Councils Privacy Policy can be found at:  
[www.gedling.gov.uk/Licensing-privacy](http://www.gedling.gov.uk/Licensing-privacy)

## Licensing Act 2003 Licensing Representation Form

If you wish you can use this form to make your representation to the Licensing Authority.

Representations can be made against a licence application by an interested party. Representations may also be made on behalf of an interested party by a representative e.g. MP, solicitor, or a friend. **Please be mindful that that your representation can be viewed by the Applicant or by a representative of the Applicant. It may also be read out in public at the Licensing Panel hearing.**

(a) **Please indicate in which capacity you are making this representation by ticking a box below:**

☒ An individual

☐ A business

☐ A person representing the individual(s)/business(es)

☐ A body representing the individual(s)/business(es)

**Representations are only relevant to an application if they relate to at least one of the four Licensing Objectives listed below:**

- 1. The Prevention of Crime and Disorder**
- 2. Public Safety**
- 3. Prevention of Public Nuisance**
- 4. The Protection of Children from Harm**

Representations may be made at any time during a period of **28 consecutive days** starting on the day after the application was given to the Licensing Authority. In the case of a closure order issued by the Police, representations may be made during the seven days that follow relevant notice being given to the Local Authority by the Magistrates Court, starting on the day after the day the notice was received.

(b) Please enter contact details of interested party below:

Name: JACK NEVILLE

Address: 5 BONINGTON ROAD, MAPPERLEY

Postcode: NG3 5JR

Telephone number (optional):

E-mail (optional):

(c) Please confirm name and address of person or business affected if different from the address given above:

Name:

Address:

Postcode:

(d) Please provide details of the application to which you wish to make a representation.

Name of Applicant: Mr LANDA

Address of Premises: 31 PLAINS ROAD WOODTHORPE NG3 5JU

Application for: NEW PREMISES LICENCE — SALE OF ALCOHOL,  
PROVISION OF REGULATED ENTERTAINMENT  
PROVISION OF LATE NIGHT REFRESHMENT  
OPENING HOURS OF THE PREMISES.



**Details of your representation** (please ensure relevance to the above licensing objectives):

Licensing objective: Prevention of Public Nuisance  
I strongly oppose the request for a 2am license. To grant this, would be to ensure breaches of the Public Nuisance objective, with local residents of the neighbouring Bonington Road being disturbed by the anti social opening hours, increased football, traffic & noise.

The request for extremely extended opening hours, into the early morning, would constitute a nuisance as it would interfere with neighbouring property owners reasonable use & enjoyment of land, by disrupting the peace and emitting significant noise, that is not proportional or reasonable to the character of the locality during such hours.

As this is also a request for change of use, such activities that are being challenged, cannot be included in an assessment of the character of the immediate area.

(Please continue on separate sheet if necessary)



(e) Please indicate which of the Licensing Objectives your representation refers to by ticking the relevant box(es) below:

☐ The Prevention of Crime and Disorder

☐ Public Safety

☒ Prevention of Public Nuisance

☐ The Protection of Children from Harm

(f) Suggest alternatives

If possible please suggest alterations to the application, or conditions that would resolve the problem mentioned above, again paying attention to the licensing objectives.

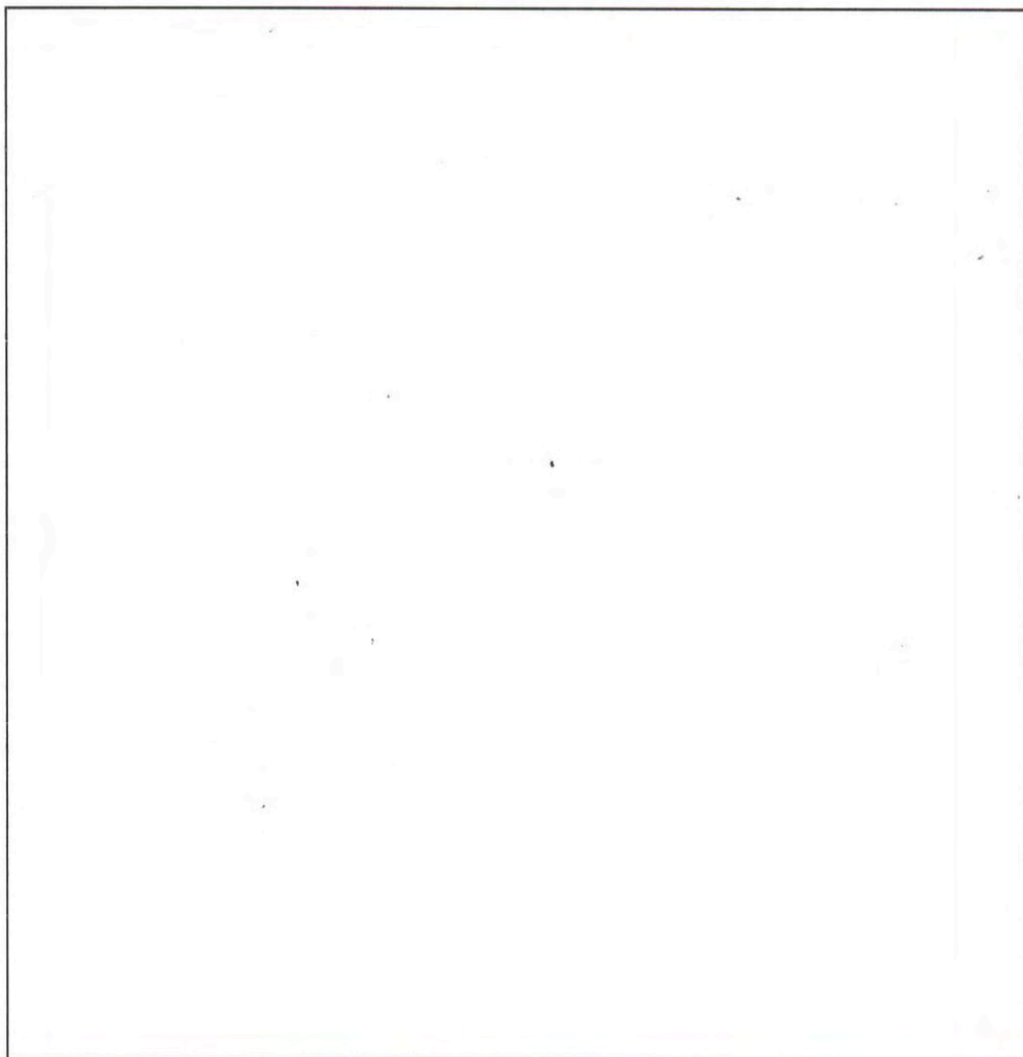

Once the Licensing Section has received this form you will receive a written acknowledgment and you may be contacted to discuss the issue prior to any referral to a Licensing Panel hearing.

☐ Please tick this box if you do not intend to attend or be represented at any hearing. This means that only your written representation will be able to be considered.

If you wish to withdraw any representations you may do so confirming this in writing to the address given below, providing you do so no later than 24 hours before the any hearing, or otherwise orally at the hearing.

Signed

PRINT NAME:

Date:

Please now return this completed form to the following address:

**Licensing Section  
Public Protection  
Gedling Borough Council  
Civic Centre  
Arnot Hill Park  
Arnold  
Nottingham NG5 6LU**

#### **Privacy Statement**

The information regarding the Councils Privacy Policy can be found at:  
[www.gedling.gov.uk/Licensing-privacy](http://www.gedling.gov.uk/Licensing-privacy)

**Licensing Act 2003  
Licensing Representation Form**

If you wish you can use this form to make your representation to the Licensing Authority.

Representations can be made against a licence application by an interested party. Representations may also be made on behalf of an interested party by a representative e.g. MP, solicitor, or a friend. **Please be mindful that that your representation can be viewed by the Applicant or by a representative of the Applicant. It may also be read out in public at the Licensing Panel hearing.**

(a) **Please indicate in which capacity you are making this representation by ticking a box below:**

- ☒ An individual
- ☐ A business
- ☐ A person representing the individual(s)/business(es)
- ☐ A body representing the individual(s)/business(es)

**Representations are only relevant to an application if they relate to at least one of the four Licensing Objectives listed below:**

- 1. The Prevention of Crime and Disorder**
- 2. Public Safety**
- 3. Prevention of Public Nuisance**
- 4. The Protection of Children from Harm**

Representations may be made at any time during a period of **28 consecutive days** starting on the day after the application was given to the Licensing Authority. In the case of a closure order issued by the Police, representations may be made during the seven days that follow relevant notice being given to the Local Authority by the Magistrates Court, starting on the day after the day the notice was received.

**(b) Please enter contact details of interested party below:**

Name: ...Stuart Parker.....

Address: 3 Bonington Road, Mapperley, Nottingham.....

Postcode: NG3 5JR.....

Telephone number (.....)

E-mail (optional): .....)

**(c) Please confirm name and address of person or business affected if different from the address given above:**

Name:.....

Address: .....

Postcode: .....

**(d) Please provide details of the application to which you wish to make a representation.**

Name of Applicant: J Landa.....

Address of Premises: 31 Plains Road, Mapperley, Nottingham,  
NG3 5JU.....

Application for: Change of use and late licence.....

**Details of your representation** (please ensure relevance to the above licensing objectives):

We are a young family living at 3 Bonington Road, neighbouring the property requesting a change of use and late licence. We make representation on the following basis:

We have a 1 year old baby the location of the beer garden and the late licence will create additional noise, light and air pollution around are home. This could affect the health, wellbeing and development of our family and child.

The Bonnington Road community is close knit and full of young families many of those are situated close to 31 Plains Road property and will be affected by this.

We already have instances of noise and anti social behaviour late at night, a bar with this late a licence will affect that, again with a beer garden being located so close to the residents.

Since the pandemic we have experienced increases in anti social behaviour, noise and disturbance throughout the area. Again a bar in this area is only going to make that worse. The council has a duty of care to protect the residents already here.

There will be increased rubbish and further instances of increased vermin, pests and flies.

Light, noise and air pollution will be increased in the area. This will be particularly prevalent in summer when we will be forced to close all doors and windows to avoid the issues.

There is already over subscribed parking in the area. Additional footfall and residents (from the flats) will add to an existing problem.  
House prices in the area will be directly affected by a late licence.

Realistically there are several bars, pubs, restaurants and food chains in the area which are half empty – can they afford to survive and Mapperley really sustain another one?

I question the sustainability and environmental impact of this development. How does this business expect to meet the requirements of COP26 and does it have a sustainability policy in place?

(e) Please indicate which of the Licensing Objectives your representation refers to by ticking the relevant box(es) below:

☒ The Prevention of Crime and Disorder

☐ Public Safety

☒ Prevention of Public Nuisance

☒ The Protection of Children from Harm

(f) Suggest alternatives

If possible please suggest alterations to the application, or conditions that would resolve the problem mentioned above, again paying attention to the licensing objectives.

I accept the inevitable counter argument that we live close to a busy high street, and there are undoubted benefits to that.

Concessions you could make to the licence are:

- Reduce the number of residential units planned. In my opinion the flats are poorly planned, laid out and will be difficult to maintain.
- Remove the beer garden area – this causes too much disruption to local residents
- The licence should be fixed at 11pm or earlier.
- Open up the car park to allow permit residents to use at all times.

Once the Licensing Section has received this form you will receive a written acknowledgment and you may be contacted to discuss the issue prior to any referral to a Licensing Panel hearing.

☐ Please tick this box if you do not intend to attend or be represented at any hearing. This means that only your written representation will be able to be considered.

If you wish to withdraw any representations you may do so confirming this in writing to the address given below, providing you do so no later than 24 hours before the any hearing, or otherwise orally at the hearing.

 t here .....

PRINT NAME: Stuart Parker.....

Date: 26/11/21.....

Please now return this completed form to the following address:

**Licensing Section  
Public Protection  
Gedling Borough Council  
Civic Centre  
Arnot Hill Park  
Arnold  
Nottingham NG5 6LU**

### **Privacy Statement**

The information regarding the Councils Privacy Policy can be found at:  
[www.gedling.gov.uk/Licensing-privacy](http://www.gedling.gov.uk/Licensing-privacy)

---

**From:** Nicola Blue <[REDACTED]>  
**Sent:** 25 November 2021 17:52  
**To:** Enquiries <[Enquiries@gedling.gov.uk](mailto:Enquiries@gedling.gov.uk)>  
**Subject:** License application Old Bank Mapperley

Good Evening,

I would like to make an objection regarding an application for the following address:

Old Bank Mapperley Ltd

31 Plains Road

Mapperley

Nottingham

NG3 5JU

I would like to object to the granting of the Licensing application.

The location of the new proposed establishment is extremely close to quiet residential areas. Noise from people leaving as late as 2am is inevitable and not acceptable for the nearby residents. This noise will not be limited to the immediate streets but will extend a lot further as people make their way home.

This can already be a bit of an issue for residents living close to Mapperley top but is currently at least limited to prior to midnight.

A business with such long opening hours is highly likely to result in antisocial behaviour by individuals both inside and outside the establishment causing a nuisance to local residents.

The planned beer garden is of great concern, again due to the inevitable noise which will be generated during the evening and night when residents including children, elderly and people who need to get up for work in the morning and trying to relax and sleep!

Mapperley is a thriving high street and I fear the proposal of showing sports will attract daytime drinkers to a family orientated area.

There will be an increase in late night traffic, using Bonington Road and Haywood Road Car Parks disturbing residents at those locations and also possible street parking on nearby streets such as Steedman Avenue which is already an issue for the residents living there.

The speed of traffic through Mapperley at night is also an ongoing issue for residents and adding intoxicated individuals to mix the mix is not a good idea.



Thank you taking my comments into consideration

Regards  
Nicola

## Licensing Act 2003 Licensing Representation Form

If you wish you can use this form to make your representation to the Licensing Authority.

Representations can be made against a licence application by an interested party. Representations may also be made on behalf of an interested party by a representative e.g. MP, solicitor, or a friend. **Please be mindful that that your representation can be viewed by the Applicant or by a representative of the Applicant. It may also be read out in public at the Licensing Panel hearing.**

(a) **Please indicate in which capacity you are making this representation by ticking a box below:**

- ☒ An individual
- ☐ A business
- ☐ A person representing the individual(s)/business(es)
- ☐ A body representing the individual(s)/business(es)

**Representations are only relevant to an application if they relate to at least one of the four Licensing Objectives listed below:**

1. The Prevention of Crime and Disorder
2. Public Safety
3. Prevention of Public Nuisance
4. The Protection of Children from Harm

Representations may be made at any time during a period of **28 consecutive days** starting on the day after the application was given to the Licensing Authority. In the case of a closure order issued by the Police, representations may be made during the seven days that follow relevant notice being given to the Local Authority by the Magistrates Court, starting on the day after the day the notice was received.



(b) Please enter contact details of interested party below:

Name: MR + MRS J STURTWANT

Address: 9 BONINGTON ROAD

Postcode: NG3 5JR

Telephone number (optional): .....

E-mail (optional): .....

(c) Please confirm name and address of person or business affected if different from the address given above:

Name: .....

Address: .....

Postcode: .....

(d) Please provide details of the application to which you wish to make a representation.

Name of Applicant: OLD BANK MAPPERLEY LIMITED

Address of Premises: 31 PLAINS ROAD, MAPPERLEY NG3 5JU

Application for: A NEW PREMISES LICENCE UNDER  
LICENSING ACT 2003.

**Details of your representation** (please ensure relevance to the above licensing objectives):

We wish to object to the granting of this licensing application. We believe there is already an over provision of licensed premises in the locality and we are already affected by noise levels at night from the existing premises on Plains Road. To add an additional venue to the end of Bonington Road, which is a residential area, we feel is inappropriate. Families of all ages live on Bonington Road, many with young children, and this venue, especially with the proposed opening times will cause significant disturbance. There will be an increase in noise from within the building as well as an increase in traffic of people coming and going by car, taxi or on foot. There is also the potential for public nuisance and antisocial behavior with alcohol on sale until 2 in the morning.

To the best of our knowledge no other business in this area has such a late night license for alcohol sales or music and entertainment and with this application there is the potential for even more serious noise disturbance and public disorder in the early hours of the morning.

(Please continue on separate sheet if necessary)



(e) Please indicate which of the Licensing Objectives your representation refers to by ticking the relevant box(es) below:

- ☒ The Prevention of Crime and Disorder

- ☐
- Public Safety

- ☒
- Prevention of Public Nuisance

- ☐ The Protection of Children from Harm

(f) Suggest alternatives

If possible please suggest alterations to the application, or conditions that would resolve the problem mentioned above, again paying attention to the licensing objectives.

This image shows a blank, aged, cream-colored page, likely an endpaper or flyleaf of a book. The paper has a slightly textured appearance with visible creases and some minor discoloration or staining, particularly a faint, irregular yellowish mark near the top center. The page is set against a dark background, which appears to be the inner cover or binding of the book.

Once the Licensing Section has received this form you will receive a written acknowledgment and you may be contacted to discuss the issue prior to any referral to a Licensing Panel hearing.

☒ Please tick this box if you do not intend to attend or be represented at any hearing. This means that only your written representation will be able to be considered.

If you wish to withdraw any representations you may do so confirming this in writing to the address given below, providing you do so no later than 24 hours before the any hearing, or otherwise orally at the hearing.

Signed: .....

PRINT NAME: JOHN STURIVANT JAYNE STURIVANT

Date: 25.11.2021

Please now return this completed form to the following address:

Licensing Section  
Public Protection  
Gedling Borough Council  
Civic Centre  
Arnot Hill Park  
Arnold  
Nottingham NG5 6LU

#### Privacy Statement

The information regarding the Councils Privacy Policy can be found at:  
[www.gedling.gov.uk/Licensing-privacy](http://www.gedling.gov.uk/Licensing-privacy)





## Licensing Act 2003 Licensing Representation Form

If you wish you can use this form to make your representation to the Licensing Authority.

Representations can be made against a licence application by an interested party. Representations may also be made on behalf of an interested party by a representative e.g. MP, solicitor, or a friend. **Please be mindful that that your representation can be viewed by the Applicant or by a representative of the Applicant. It may also be read out in public at the Licensing Panel hearing.**

(a) Please indicate in which capacity you are making this representation by ticking a box below:

- ☒ An individual
- ☐ A business
- ☐ A person representing the individual(s)/business(es)
- ☐ A body representing the individual(s)/business(es)

Representations are only relevant to an application if they relate to at least one of the four Licensing Objectives listed below:

1. The Prevention of Crime and Disorder
2. Public Safety
3. Prevention of Public Nuisance
4. The Protection of Children from Harm

Representations may be made at any time during a period of **28 consecutive days** starting on the day after the application was given to the Licensing Authority. In the case of a closure order issued by the Police, representations may be made during the seven days that follow relevant notice being given to the Local Authority by the Magistrates Court, starting on the day after the day the notice was received.

(b) Please enter contact details of interested party below:

Name: CARL JONES

Address: 6 BENNETT ROAD, MAPPERLEY, NOTTINGHAM

Postcode: NG3 6BQ

Telephone number (optional): .....

E-mail (optional): .....

(c) Please confirm name and address of person or business affected if different from the address given above:

Name: .....

Address: .....

Postcode: .....

(d) Please provide details of the application to which you wish to make a representation.

Name of Applicant: MR LANDA

Address of Premises: 31 Plains Rd, Mapperley, Nottm NG3 5JU

Application for: Sale of alcohol, regular entertainment

between hours of 08:00 → 02:00hrs (Monday to Sunday)

Provision of late night refreshment 23:00 → 02:00hrs (M→S)

Opening of the business from 06:00hrs → 02:30hrs.



**Details of your representation** (please ensure relevance to the above licensing objectives):

It is unclear as to the precise nature of this proposed business, though appears to be wishing to operate a night club. I see <sup>②</sup> overlent and do object as a local resident to the allowance of such a business and activity anywhere within the Mapperley commercial area.

There are a large number of licensed premises within this area, one of which is licensed to 01:00hrs which alone causes significant negative impact to the local amenity.

The proposal for this business to be open until 02:00 (Monday-Sunday), with the provision for live/recorded music, will in my view cause a significant noise nuisance to the adjoining local amenity which is dense and significantly close to the premises.

Having the latest license in the area, will attract customers from outside the local area to late night drinking activity, which will likely result in increased crime + disorder and also be of concern to the local community in terms of public safety.

This type of business would be better suited and managed within a town/city location, where impact on the amenity would be significantly less and responsible authorities (Police etc) would be able to better support, the proposed hours of business.

(Please continue on separate sheet if necessary)  
The nature + long hours of business are also likely

to attract young people/children ~~and~~ who could potentially be harmed by the activity of the business and its customers.

Mapperley is a row of commercial shops/units surrounded by residential community. This proposal would significantly change + harm the character of Mapperley.

②.

④

It is noted the bar area states a maximum capacity of 220 persons. This would represent a large number of persons entering and later leaving the Plains road area and would require regulation to ensure public protection, prevention of crime and disorder (particularly after 02:00hrs) where customers would be likely to be intoxicated with alcohol.

There also needs to be significant attention to the likely public nuisance by noise and behaviour at such times after 23:00hrs as proposed.

(e) Please indicate which of the Licensing Objectives your representation refers to by ticking the relevant box(es) below:

☒ The Prevention of Crime and Disorder

☒ Public Safety

☒ Prevention of Public Nuisance

☒ The Protection of Children from Harm

(f) Suggest alternatives

If possible please suggest alterations to the application, or conditions that would resolve the problem mentioned above, again paying attention to the licensing objectives.

Allow alcohol to be served no later than  
23:00hrs in line and parity with the  
majority of licensed businesses in the area.

Deny the application for the provision of late-night  
refreshment on the grounds of (e) above

Reduce the provision of regulated entertainment  
to 23:00hrs Monday to Sunday.

Significant planning boundaries and rules be  
put in place to manage noise and public  
nuisance to protect the local amenity

Once the Licensing Section has received this form you will receive a written acknowledgment and you may be contacted to discuss the issue prior to any referral to a Licensing Panel hearing.

☒ Please tick this box if you do not intend to attend or be represented at any hearing. This means that only your written representation will be able to be considered.

If you wish to withdraw any representations you may do so confirming this in writing to the address given below, providing you do so no later than 24 hours before the any hearing, or otherwise orally at the hearing.

Sign

PRINT NAME:

Date:

Please now return this completed form to the following address:

Licensing Section  
Public Protection  
Gedling Borough Council  
Civic Centre  
Arnot Hill Park  
Arnold  
Nottingham NG5 6LU

#### Privacy Statement

The information regarding the Councils Privacy Policy can be found at:  
[www.gedling.gov.uk/Licensing-privacy](http://www.gedling.gov.uk/Licensing-privacy)

---

**From:** Bruce Roberts [REDACTED]  
**Sent:** 23 November 2021 09:09  
**To:** Enquiries <[Enquiries@gedling.gov.uk](mailto:Enquiries@gedling.gov.uk)>  
**Subject:** Old Bank Mapperley Ltd

To the Licensing Officer – Gedling Borough Council

**Objection:**  
Old Bank Mapperley Ltd  
31 Plains Road  
Mapperley  
Nottingham  
NG3 5JU

To whomever it may concern,

I formally wish to object the granting of the Licensing application.

The location is extremely close to quiet residential housing and the noise generated by clientele using nearby streets to travel home during the early hours of the morning will be intrusive.

As with the existing licensed premises that do close by 11:30, users may be quiet as they leave the building but this is respectful silence is quickly forgotten as they walk through residential streets nearby.

Gedling Borough Council have already demonstrated an inability to control illegal electric scooter usage and illegal road speed and noise. We have no confidence GBC will be able to control early morning fuelled illegal behaviour generated by this venue.

A business whose principle hours are so extensive, being from 08:00 to 02:00 will mean the potential for noise and antisocial behaviour outside of these hours. Closing at 02:00 and starting at 08:00 will give local residents a FOUR hour window of opportunity to get disruption free sleep on a hot summer's night with the windows open as we cannot afford the type of air conditioning afforded the staff and clients and many of us have to set our alarm clocks for 06:00 as we have to work during the day.

There is a plan for a beer garden generating noise late at night when residents and their children will be trying to sleep. This is not acceptable late at night.

Looking at the plans, access to the waste bin stores is only from the street, meaning that staff waste disposal will be carried out at the end of shifts meaning noise until 02:30 on Bonington Road

Their will be increased late night traffic using Bonington Road and Haywood Road Car Parks disturbing residents at those locations.

Night buses only run in the direction of Nottingham City and ONLY on Friday and Saturday nights. There are only two buses after this proposed closing time, the first of which is 40 minutes after the proposed closure of The Old Bank, meaning intoxicated individuals choosing to travel by bus will be hanging around for considerable periods. Where alcohol is involved, the possibility for inappropriate behaviour is increased, with residential properties and gardens in the immediate vicinity and no public toilets, the possibly of people not in total control of all their faculties and their bladders could lead to antisocial behaviour.

Mapperley is not a busy location at night. This application brings increased risk of attack to lone individuals, male or female being intoxicated and unable to defend themselves.

Clients parking vehicles on the street at night has its inevitable risks attached. If that risk of possible damage is increased by introducing a considerable number of people, late at night and having been in an environment where alcohol and possibly other substances are involved, then this is not an acceptable risk to have placed on existing residents.

The speed of traffic through Mapperley at night has long been an issue for residents. Traffic speeds calculated in excess of 65MPH have been noted on numerous occasions. Adding intoxicated individuals into an environment without traffic speed control cameras is a recipe for disaster. Police and councillors were contacted in May 2020 and the situation has only got worse.

Persons contacted then included Notts Police: Mike Ebbins, DS2706,

Mapperley at various times of day – audio recorded 9<sup>th</sup> May 2020: [https://www.youtube.com/watch?v=Jg\\_WI7sSxPA](https://www.youtube.com/watch?v=Jg_WI7sSxPA) (Not all speeding – some noise issues. Not acceptable during the day but impossible to accept in the early hours of the morning)

Generally any activity involving increased numbers of people, vehicles, music and alcohol after 11:30 at night is not appropriate for a residential area and it increases the possibility of becoming a public nuisance.

Finally, any organisation that cannot follow the rules pertaining to making a controversial license application whilst still being able to follow the same rules for making a building planning application make themselves appear to having something to hide. Being able to post the building planning application on the lamp post, whilst hiding the licensing application in the windows obscured and made inaccessible by scaffolding in breach of the licensing application process in my view indicates the organisation has something to hide and is trying to avoid public scrutiny. (see picture below.) This was raised with Licensing Officer Paul Gibbs.

If they are willing to avoid scrutiny at this stage, what commitment will they have to consideration of the wider Mapperley Community, should they be successful?



Bruce Roberts

M. +44 (0) 788-418-1400



**From:** Mark Vasey [REDACTED] >  
**Sent:** 22 November 2021 17:39  
**To:** Enquiries <[Enquiries@gedling.gov.uk](mailto:Enquiries@gedling.gov.uk)>  
**Subject:** Planning Permission regards Change of Use to 31 Plains Road Mapperley

Dear Sir/Madam

I contact you regarding the above matter as I wish to raise a couple of concerns that I have regarding the potential change of use and licensing application.

Firstly, I am concerned about the impact on myself and other neighbours if permission is granted to allow the premises to be in use until 2am. There will be noise coming from persons visiting the premises and returning to their cars which will be parked in the car park to the rear. My property backs on to this car park and it is already very busy and can be noisy at times, by allowing the new premises to be open until 2am this will make matters worse and have a significant impact on nearby residential properties.

Residents in Mapperley have seen a significant increase in night time businesses opening up in recent years and this has been to the detriment of persons that live in the area. These premises do not seem to care for the local residents and create noise due to the volume of visitors and associated drunken behaviour. We are often disturbed by loud music being played from the Blues Dawg pub during the summer months particularly and friends of ours suffer disturbances from visitors to the Topsy Tea.

Secondly, I understand that flats are to be built at the premises. Can I ask whether these flats will be given parking permits either for the car park or whether they will be given permits to park on nearby residential roads. The two roads that adjoin the premises are Gretton Road and Bonnington Road, both of which have very little in the way of off street parking and so residents rely on the use of permits to park closely to their own premises. Granting permits for either of these roads would have a significant detrimental effect on the quality of life for those persons who already live there.

Please can I be updated regards my comments.

Yours sincerely, Mark Vasey





## Licensing Act 2003 Licensing Representation Form

If you wish you can use this form to make your representation to the Licensing Authority.

Representations can be made against a licence application by an interested party. Representations may also be made on behalf of an interested party by a representative e.g. MP, solicitor, or a friend. **Please be mindful that that your representation can be viewed by the Applicant or by a representative of the Applicant. It may also be read out in public at the Licensing Panel hearing.**

(a) Please indicate in which capacity you are making this representation by ticking a box below:

☒ An individual

☐ A business

☐ A person representing the individual(s)/business(es)

☐ A body representing the individual(s)/business(es)

**Representations are only relevant to an application if they relate to at least one of the four Licensing Objectives listed below:**

1. The Prevention of Crime and Disorder
2. Public Safety
3. Prevention of Public Nuisance
4. The Protection of Children from Harm

Representations may be made at any time during a period of **28 consecutive days** starting on the day after the application was given to the Licensing Authority. In the case of a closure order issued by the Police, representations may be made during the seven days that follow relevant notice being given to the Local Authority by the Magistrates Court, starting on the day after the day the notice was received.

(b) Please enter contact details of interested party below:

Name: LINDA & GEORGE WILDMAN.....

Address: 10 BONINGTON ROAD, MAPPERLEY, NOTTINGHAM

Postcode: N93 5JR.....

Telephone number (optional): [REDACTED]

E-mail (optional): [REDACTED]

(c) Please confirm name and address of person or business affected if different from the address given above:

Name:.....

Address: .....

Postcode: .....

(d) Please provide details of the application to which you wish to make a representation.

Name of Applicant: OLD BANK MAPPERLEY LTD.....

Address of Premises: 31 PLAINS ROAD, MAPPERLEY, N93 5JR

Application for: ① SUPPLY OF ALCOHOL & REGULATED ENTERTAINMENT

From 0:00 to 02:00 Mondays to Sundays.

② TO PROVIDE LATE NIGHT REFRESHMENT FROM 23:00 TO 02:00 MONDAYS TO SUNDAYS

③ TO PROVIDE LICENSABLE ACTIVITIES ON SPECIAL OCCASIONS

- (e) Please indicate which of the Licensing Objectives your representation refers to by ticking the relevant box(es) below:

☐ The Prevention of Crime and Disorder

☐ Public Safety

☒ Prevention of Public Nuisance

☐ The Protection of Children from Harm

- (f) Suggest alternatives

If possible please suggest alterations to the application, or conditions that would resolve the problem mentioned above, again paying attention to the licensing objectives.

To restrict the licensing hours to midnight at the latest.

- (e) Please indicate which of the Licensing Objectives your representation refers to by ticking the relevant box(es) below:

☐ The Prevention of Crime and Disorder

☐ Public Safety

☒ Prevention of Public Nuisance

☐ The Protection of Children from Harm

- (f) Suggest alternatives

If possible please suggest alterations to the application, or conditions that would resolve the problem mentioned above, again paying attention to the licensing objectives.

To restrict the licensing hours to midnight at the latest.



Details of your representation (please ensure relevance to the above licensing objectives):

'The Old Bank' is on the corner of a road which is mainly residential (BONINGTON ROAD). There are already many bars and restaurants on Plain's Road and midnight is the time some of them are open <sup>especially on Fridays & Saturdays</sup> ~~until around midnight~~. The public houses close around 11 pm.

It can often be quite noisy when people are leaving these premises and yet they are further away from Bonington Road than the 'Old Bank'.

If the licensing hours are going to be until 02:00 then this is obviously going to be disruptive to the area.

Once the Licensing Section has received this form you will receive a written acknowledgment and you may be contacted to discuss the issue prior to any referral to a Licensing Panel hearing.

☒ Please tick this box if you do not intend to attend or be represented at any hearing. This means that only your written representation will be able to be considered.

If you wish to withdraw any representations you may do so confirming this in writing to the address given below, providing you do so no later than 24 hours before the any hearing, or otherwise orally at the hearing.

Signed:

PRINT NAME: ANDREW M. SALOMAN

Date: 25/11/2021

Please now return this completed form to the following address:

Licensing Section  
Public Protection  
Gedling Borough Council  
Civic Centre  
Arnot Hill Park  
Arnold  
Nottingham NG5 6LU

#### Privacy Statement

The information regarding the Councils Privacy Policy can be found at:  
[www.gedling.gov.uk/Licensing-privacy](http://www.gedling.gov.uk/Licensing-privacy)

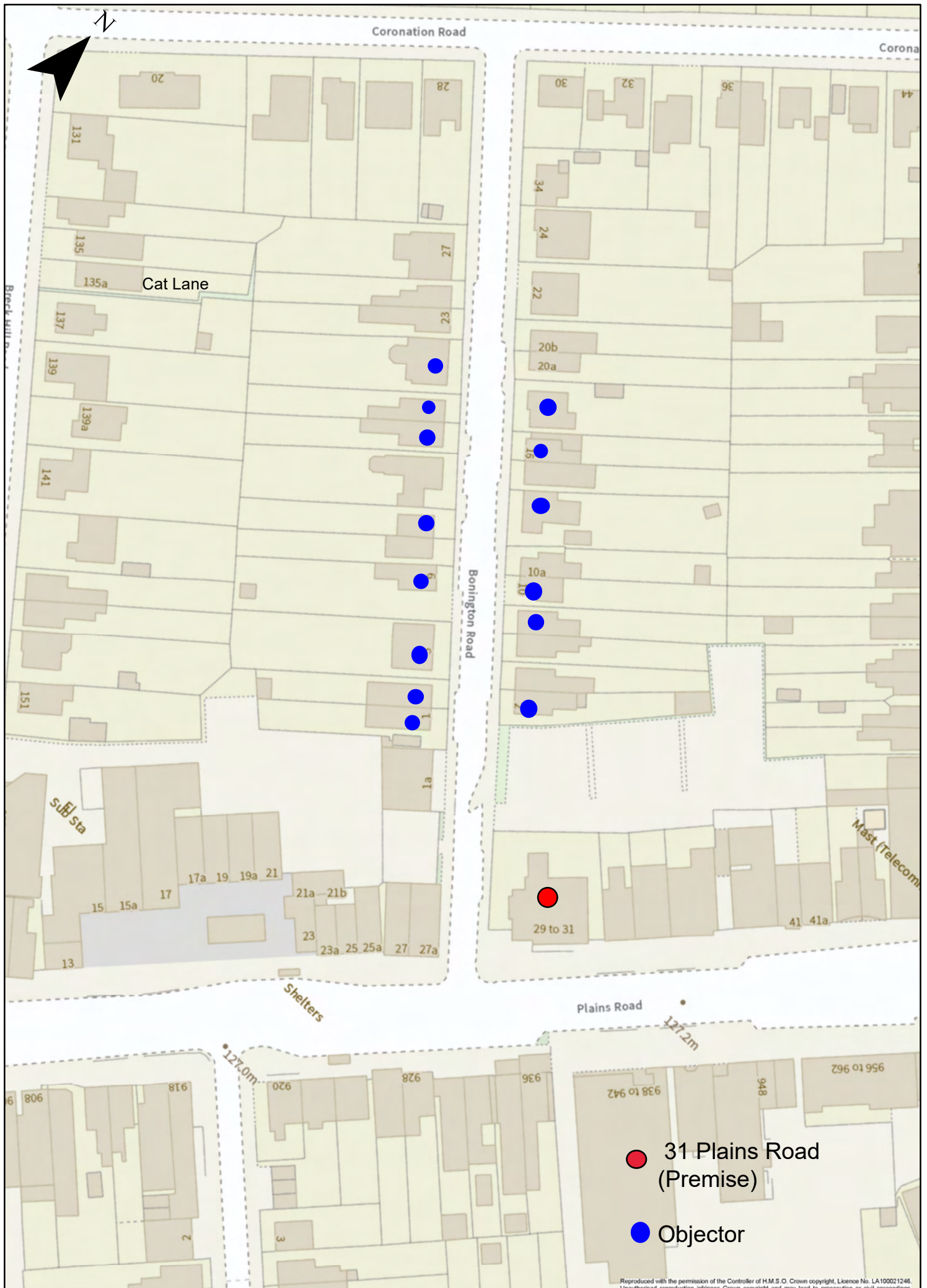

Reproduced with the permission of the Controller of H.M.S.O. Crown copyright, Licence No. LA100021246. Unauthorised reproduction infringes Crown copyright and may lead to prosecution or civil proceedings.



4

# Other Representations

---

**From:** Paul Horton <[REDACTED]uk>  
**Sent:** 26 November 2021 11:12  
**To:** Enquiries <Enquiries@gedling.gov.uk>  
**Cc:** Rachel Pentlow <Rachel.Pentlow@gedling.gov.uk>; Paul Gibbs <Paul.Gibbs@gedling.gov.uk>; Pearson, Chris, INSP3606 [REDACTED]k>  
**Subject:** FW: Application for a Premise Licence - Old Bank Mapperley Ltd 31 Plains Road Mapperley Nottingham NG3 5JU  
**Importance:** High

Good Morning,

I can confirm Nottinghamshire Police has received an Application for a Premise Licence for Old Bank Mapperley Ltd 31 Plains Road Mapperley Nottingham NG3 5JU

Please find below agreement from the applicants client with amended times and conditions to be attached to the Premise Licence

Revised Timings

-

Films

Monday – Sunday 0800 – 0100

Plays

Monday – Sunday 0800 – 0100

Indoor Sporting events

Monday – Sunday 0800 – 0100

Live Music

Monday – Sunday 0800 – 0100

Recorded Music

Monday – Sunday 0800 – 0100

Performances of Dance

Monday – Sunday 0800 – 0100

Anything of a similar Description

Monday – Sunday 0800 – 0100

Late Night Refreshment (indoors and outdoors)

Monday – Sunday 2300 – 0100

Supply of Alcohol (on and off)

Monday – Sunday 0800 – 0100

Hours open to the Public

Monday – Sunday 0600 – 0130

Applies to all of the above

-

- If applicable, an additional hour to the standard and non-standard times on the day when British summertime commences.
- From the standard start timing on 31st December to the standard start time on the 1st January.

## **Conditions**

1. A CCTV system with recording equipment shall be installed prior to the premises carrying out licensable activities and maintained in accordance with the system. It shall be recording at all times the premises is open to the public.

All recordings used in conjunction with CCTV shall:

- i. be of evidential quality
  - ii. cover the point of sale, outside area and entrance and exit
  - iii. indicate the time and date
  - iv. be retained for a period of 31 days
  - v. sufficient staff will be trained to use the system
  - vi. the original images will be made available for inspection immediately upon the request of Police officers, or other authorised officers.
  - vii. copies of recordings shall be provided in a format which can be viewed on readily available equipment without the need for specialist software.
2. Door supervisors shall be employed at the premises on occasions as deemed necessary by the Designated Premises Supervisor and/or premises management following a risk assessment and/or on occasions when requested by, and following consultation with the Police.
  3. The external areas of the premise will be closed and vacated by all customers by 23:00 hrs Monday to Sunday.
  4. Alcoholic and other drinks may not be removed from the premises in open containers save for the consumption in any external area provided for that purpose.
  5. A bound and sequentially paginated incident book or electronic record shall be kept to record all instances of disorder, damage to property and personal injury at the premises. Such records are to be made available for inspection and copying by the Police and other officers of Responsible Authorities upon request, and all such records to be retained at the premises for at least 12 months.
  6. A bound and sequentially paginated refusals book or electronic record shall be kept at the premises to record all instances where admission or service is refused. Details to show:

- The basis of the refusal.

- The person making the decision to refuse; and
- The date and time of the refusal

Such books/records to be retained at the premises for at least 12 months and shall be made available for inspection and copying by the Police, or other officers of a Responsible Authority upon request.

7. All staff engaged or to be engaged in the sale of alcohol on the premises, except personal licence holders, shall receive the following training in age restricted sales:
  - Induction training which must be completed and documented prior to the sale of alcohol by the staff member.
  - Training records will be retained at the premises for a minimum period of 12 months and available for inspection upon request by a Police Officer and/or authorised person
8. A Challenge 21 scheme shall operate at the premises. Any person who appears to be under 21 years of age shall not be served alcohol unless they produce an acceptable form of identification (passport, photo driving licence, Military Identity card or PASS accredited card).

Kind Regards

**Paul Horton (7271)**  
**Senior Licensing Officer**  
**County Division**

Local Policing Unit ( Licensing)  
 Nottinghamshire Police  
 Mansfield Police Station  
 Great Central Road  
 Mansfield  
 Nottinghamshire NG18 2HQ

[REDACTED]  
 [REDACTED]  
 [REDACTED]  
 [REDACTED]

Police Non Emergency Dial 101

[REDACTED]

Unless otherwise stated please treat as restricted

Internet e-mail is not to be treated as a secure means of communication. Nottinghamshire Police monitors all Internet e-mail activity and content. This communication is intended for the addressee(s) only. Please notify the sender if received in error. Unauthorised use or disclosure of the content may be unlawful. There is no intent, by Nottinghamshire Police, that this e-mail should constitute a legally binding document, nor do opinions expressed herein necessarily represent official policy.

Find out about Nottinghamshire Police by visiting [www.nottinghamshire.police.uk](http://www.nottinghamshire.police.uk)